

**Pioneer** *sound.vision.soul*

**AUDIO/VIDEO MULTI-CHANNEL  
RECEIVER**

**VSX-41**

**ELITE**

Operating Instructions

**WARNING: TO PREVENT FIRE OR SHOCK HAZARD, DO NOT EXPOSE THIS APPLIANCE TO RAIN OR MOISTURE.**

**WARNING:** THE APPARATUS IS NOT WATERPROOFS, TO PREVENT FIRE OR SHOCK HAZARD, DO NOT EXPOSE THIS APPLIANCE TO RAIN OR MOISTURE AND DO NOT PUT ANY WATER SOURCE NEAR THIS APPARATUS, SUCH AS VASE, FLOWER POT, COSMETICS CONTAINER AND MEDICINE BOTTLE ETC. H001AEh

[For Canadian model]

**CAUTION:** TO PREVENT ELECTRIC SHOCK, DO NOT USE THIS (POLARIZED) PLUG WITH AN EXTENSION CORD, RECEPTACLE OR OTHER OUTLET UNLESS THE BLADES CAN BE FULLY INSERTED TO PREVENT BLADE EXPOSURE.

**ATTENTION:** POUR PREVENIR LES CHOCS ELECTRIQUES NE PAS UTILISER CETTE FICHE POLARISEE AVEC UN PROLONGATEUR UNE PRISE DE COURANT OU UNE AUTRE SORTIE DE COURANT, SAUF SI LES LAMES PEUVENT ETRE INSEREES A FOND SANS EN LAISSER AUCUNE PARTIE A DECOUVERT. H007A2L

**[For Canadian model]**

This Class B digital apparatus complies with Canadian ICES-003.

**[Pour le modèle Canadien]**

Cet appareil numérique de la classe B est conforme à la norme NMB-003 du Canada. H009 2L

If the socket outlets on the associated equipment are not suitable for the plug supplied with the product, the plug must be removed and an appropriate one fitted. Replacement and mounting of an AC plug on the power supply cord of this unit should be performed only by qualified service personnel. The cut-off plug must be disposed of as an electrical shock hazard could exist if connected to a socket outlet. H022AEh

[For U.S. model]



ENERGY STAR® and the ENERGY STAR certification mark are registered US marks. K001A\_En

**CAUTION:**

THE STANDBY/ON BUTTON IS SECONDARY CONNECTED AND THEREFORE DOES NOT SEPARATE THE UNIT FROM MAINS POWER IN STANDBY POSITION. THEREFORE INSTALL THE UNIT SUITABLE PLACES EASY TO DISCONNECT THE MAINS PLUG IN CASE OF THE ACCIDENT. THE MAINS PLUG OF UNIT SHOULD BE UNPLUGGED FROM THE WALL SOCKET WHEN LEFT UNUSED FOR A LONG PERIOD OF TIME. H017BEh

Thank you for buying this Pioneer product. Please read through these operating instructions so you will know how to operate your model properly. After you have finished reading the instructions, put them away in a safe place for future reference.

**IMPORTANT NOTICE**

H006AEh

The serial number for this equipment is located in the rear panel. Please write this serial number on your enclosed warranty card and keep it in a secure area. This is for your security.

**NOTE:** This equipment has been tested and found to comply with the limits for a Class B digital device, pursuant to Part 15 of the FCC Rules. These limits are designed to provide reasonable protection against harmful interference in a residential installation. This equipment generates, uses, and can radiate radio frequency energy and, if not installed and used in accordance with the instructions, may cause harmful interference to radio communications. However, there is no guarantee that interference will not occur in a particular installation. If this equipment does cause harmful interference to radio or television reception, which can be determined by turning the equipment off and on, the user is encouraged to try to correct the interference by one or more of the following measures:

- Reorient or relocate the receiving antenna.
- Increase the separation between the equipment and receiver.
- Connect the equipment into an outlet on a circuit different from that to which the receiver is connected.
- Consult the dealer or an experienced radio/TV technician for help. H010 En

**Information to User**

Alteration or modifications carried out without appropriate authorization may invalidate the user's right to operate the equipment. H011 En

**CAUTION:**

This product satisfies FCC regulations when shielded cables and connectors are used to connect the unit to other equipment. To prevent electromagnetic interference with electric appliances such as radios and televisions, use shielded cables and connectors for connections. H012 En

Re-Equalization and the "Re-EQ" logo are trademarks of LucasFilm Ltd.

Manufactured under license from LucasFilm Ltd.

# IMPORTANT



The lightning flash with arrowhead symbol, within an equilateral triangle, is intended to alert the user to the presence of uninsulated "dangerous voltage" within the product's enclosure that may be of sufficient magnitude to constitute a risk of electric shock to persons.



**CAUTION:**  
**TO PREVENT THE RISK OF ELECTRIC SHOCK, DO NOT REMOVE COVER (OR BACK). NO USER-SERVICEABLE PARTS INSIDE. REFER SERVICING TO QUALIFIED SERVICE PERSONNEL.**



The exclamation point within an equilateral triangle is intended to alert the user to the presence of important operating and maintenance (servicing) instructions in the literature accompanying the appliance.

# IMPORTANT SAFETY INSTRUCTIONS

H003 En

**READ INSTRUCTIONS** — All the safety and operating instructions should be read before the product is operated.

**RETAIN INSTRUCTIONS** — The safety and operating instructions should be retained for future reference.

**HEED WARNINGS** — All warnings on the product and in the operating instructions should be adhered to.

**FOLLOW INSTRUCTIONS** — All operating and use instructions should be followed.

**CLEANING** — Unplug this product from the wall outlet before cleaning. The product should be cleaned only with a polishing cloth or a soft dry cloth. Never clean with furniture wax, benzene, insecticides or other volatile liquids since they may corrode the cabinet.

**ATTACHMENTS** — Do not use attachments not recommended by the product manufacturer as they may cause hazards.

**WATER AND MOISTURE** — Do not use this product near water — for example, near a bathtub, wash bowl, kitchen sink, or laundry tub; in a wet basement; or near a swimming pool; and the like.

**ACCESSORIES** — Do not place this product on an unstable cart, stand, tripod, bracket, or table. The product may fall, causing serious injury to a child or adult, and serious damage to the product. Use only with a cart, stand, tripod, bracket, or table recommended by the manufacturer, or sold with the product. Any mounting of the product should follow the manufacturer's instructions, and should use a mounting accessory recommended by the manufacturer.

**CART** — A product and cart combination should be moved with care. Quick stops, excessive force, and uneven surfaces may cause the product and cart combination to overturn.



**VENTILATION** — Slots and openings in the cabinet are provided for ventilation and to ensure reliable operation of the product and to protect it from overheating, and these openings must not be blocked or covered. The openings should never be blocked by placing the product on a bed, sofa, rug, or other similar surface. This product should not be placed in a built-in installation such as a bookcase or rack unless proper ventilation is provided or the manufacturer's instructions have been adhered to.

**POWER SOURCES** — This product should be operated only from the type of power source indicated on the marking label. If you are not sure of the type of power supply to your home, consult your product dealer or local power company.

**LOCATION** — The appliance should be installed in a stable location.

**NONUSE PERIODS** — The power cord of the appliance should be unplugged from the outlet when left unused for a long period of time.

## GROUNDING OR POLARIZATION

● If this product is equipped with a polarized alternating current line plug (a plug having one blade wider than the other), it will fit into the outlet only one way. This is a safety feature. If you are unable to insert the plug fully into the outlet, try reversing the plug. If the plug should still fail to fit, contact your electrician to replace your obsolete outlet. Do not defeat the safety purpose of the polarized plug.

● If this product is equipped with a three-wire grounding type plug, a plug having a third (grounding) pin, it will only fit into a grounding type power outlet. This is a safety feature. If you are unable to insert the plug into the outlet, contact your electrician to replace your obsolete outlet. Do not defeat the safety purpose of the grounding type plug.

**POWER-CORD PROTECTION** — Power-supply cords should be routed so that they are not likely to be walked on or pinched by items placed upon or against them, paying particular attention to cords at plugs, convenience receptacles, and the point where they exit from the product.

**OUTDOOR ANTENNA GROUNDING** — If an outside antenna or cable system is connected to the product, be sure the antenna or cable system is grounded so as to provide some protection against voltage surges and built-up static charges. Article 810 of the National Electrical Code, ANSI/NFPA 70, provides information with regard to proper grounding of the mast and supporting structure, grounding of the lead-in wire to an antenna discharge unit, size of grounding conductors, location of antenna-discharge unit, connection to grounding electrodes, and requirements for the grounding electrode. See Figure A.

**LIGHTNING** — For added protection for this product during a lightning storm, or when it is left unattended and unused for long periods of time, unplug it from the wall outlet and disconnect the antenna or cable system. This will prevent damage to the product due to lightning and power-line surges.

**POWER LINES** — An outside antenna system should not be located in the vicinity of overhead power lines or other electric light or power circuits, or where it can fall into such power lines or circuits. When installing an outside antenna system, extreme care should be taken to keep from touching such power lines or circuits as contact with them might be fatal.

**OVERLOADING** — Do not overload wall outlets, extension cords, or integral convenience receptacles as this can result in a risk of fire or electric shock.

**OBJECT AND LIQUID ENTRY** — Never push objects of any kind into this product through openings as they may touch dangerous voltage points or short-out parts that could result in a fire or electric shock. Never spill liquid of any kind on the product.

**SERVICING** — Do not attempt to service this product yourself as opening or removing covers may expose you to dangerous voltage or other hazards. Refer all servicing to qualified service personnel.

**DAMAGE REQUIRING SERVICE** — Unplug this product from the wall outlet and refer servicing to qualified service personnel under the following conditions:

- When the power-supply cord or plug is damaged.
  - If liquid has been spilled, or objects have fallen into the product.
  - If the product has been exposed to rain or water.
  - If the product does not operate normally by following the operating instructions. Adjust only those controls that are covered by the operating instructions as an improper adjustment of other controls may result in damage and will not attempt extensive work by a qualified technician to restore the product to its normal operation.
  - If the product has been dropped or damaged in any way.
  - When the product exhibits a distinct change in performance — this indicates a need for service.
- REPLACEMENT PARTS** — When replacement parts are required, be sure the service technician has used replacement parts specified by the manufacturer or have the same characteristics as the original part. Unauthorized substitutions may result in fire, electric shock, or other hazards.

**SAFETY CHECK** — Upon completion of any service or repairs to this product, ask the service technician to perform safety checks to determine that the product is in proper operating condition.

**WALL OR CEILING MOUNTING** — The product should not be mounted to a wall or ceiling.

**HEAT** — The product should be situated away from heat sources such as radiators, heat registers, stoves, or other products (including amplifiers) that produce heat.

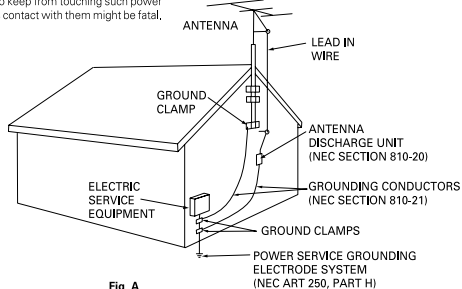

Fig. A

NEC — NATIONAL ELECTRICAL CODE

Manufactured under license from Dolby Laboratories. "Dolby", "Pro Logic" and the double D symbol are trademarks of Dolby Laboratories.

"DTS", "DTS-ES Extended Surround" and "Neo:6" are trademarks of Digital Theater Systems, Inc.

# Contents

## 1 Before you start

Checking what's in the box .....	6
Installing the receiver .....	6
Making cable connections .....	6
Loading the batteries .....	6
Operating range of remote control unit .....	6

## 2 5 minute guide

Introduction to home theater .....	7
Listening to Surround Sound .....	8
Using the Quick Setup .....	12

## 3 Connecting up

Audio/Video cords .....	13
S-video cables .....	13
Component video cords .....	13
Digital audio coaxial cords/ Optical cables .....	13
Connecting digital components .....	14
Connecting audio components .....	15
Connecting DVD 5.1 channel components ...	16
Connecting video components .....	16
Connecting to the front panel video terminal .....	17
Connecting antennas .....	18
FM wire antenna .....	18
AM loop antenna .....	18
Antenna snap connectors .....	18
Using external antennas .....	18
To improve FM reception .....	18
To improve AM reception .....	18
Connecting the speakers .....	19
Speaker terminals .....	20
A and B speaker systems .....	20
Hints on speaker placement .....	20
Connecting additional amplifiers .....	22
AC outlet .....	23
Operating other Pioneer components .....	23

## 4 Controls and displays

Front panel .....	24
Display .....	25
Remote control .....	27

## 5 Playing sources

Introduction to Sound Modes .....	30
Stereo/Direct .....	30
Standard mode .....	30
Advanced Surround modes .....	31
Choosing the input signal .....	32
Listening to multichannel playback .....	32
Using Stereo/Direct .....	33
Using Advanced Surround .....	33
Using Loudness and Midnight listening .....	33
Using the tone controls .....	34
Playing other sources .....	34
Selecting the multichannel analog inputs ....	35
Using Re-Equalization .....	35

## 6 Setting up your receiver

Choosing your receiver setup .....	36
Speaker setting .....	37
Surround back speaker setting .....	37
6.1 channel setting .....	38
Subwoofer setting .....	38
Crossover frequency setting .....	38
LFE attenuator setting .....	39
Front speaker distance setting .....	39
Center speaker distance setting .....	39
Surround speaker distance setting .....	39
Surround back speaker distance setting .....	39
Dynamic range control setting .....	40
Dual mono setting .....	40
Component video input settings .....	40
Surround back channel input setting .....	40

Coaxial digital input settings .....	41
Optical digital input settings .....	41
Setting the relative volume level of each channel .....	42

## **7 Using the tuner**

Listening to the radio .....	43
Improving FM stereo sound .....	43
Tuning directly to a station .....	43
Saving station presets .....	44
Naming station presets .....	45
Listening to station presets .....	45

## **8 Making a recording**

Making an audio or a video recording .....	46
Monitoring your recording .....	46

## **9 Controlling the rest of your system**

Setting the remote to control other components .....	47
Selecting preset codes directly .....	47
Setting Up Using Full Library Search .....	48
Searching for preset codes using brand names .....	49
Programming signals from other remote controls .....	49
Erasing one of the remote control button settings .....	50
Clearing all the remote control settings .....	50
Direct function .....	51
Confirming preset codes .....	51
Controls for TVs .....	52
Controls for other components .....	53
Preset Code List .....	55

## **10 Additional information**

Troubleshooting .....	67
Specifications .....	69
Cleaning the unit .....	70

## Checking what's in the box

Please check that you've received the following supplied accessories:

- AM loop antenna
- FM wire antenna
- Dry cell batteries x 2 (AA size IEC LR6)
- Remote control
- These operating instructions

## Installing the receiver

Please note the following points:

- Do not place objects directly on top of this unit. This prevents proper heat dispersal.
- When installing on a rack, shelf, etc., be sure to leave more than 8 inches (20 cm.) of space above the receiver.

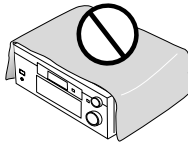

## Making cable connections

Make sure not to bend the cables over the top of this unit (as shown in the illustration). If this happens, the magnetic field produced by the transformers in this unit may cause a humming noise from the speakers.

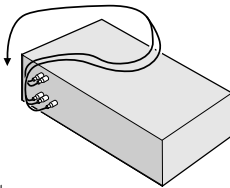

## Loading the batteries

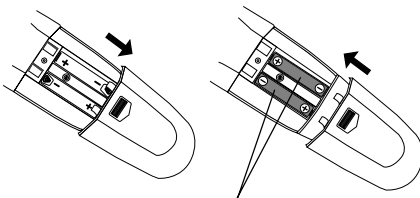

Dry cell batteries x 2 (AA size IEC LR6)



### Caution

Incorrect use of batteries may result in such hazards as leakage and bursting. Observe the following precautions:

- Never use new and old batteries together.
- Insert the plus and minus sides of the batteries properly according to the marks in the battery case.
- Batteries with the same shape may have different voltages. Do not use different batteries together.
- When disposing of used batteries, please comply with governmental regulations or environmental public instruction's rules that apply in your country or area.

## Operating range of remote control unit

The remote control may not work properly if:

- There are obstacles between the remote control and the receiver's remote sensor.
- Direct sunlight or fluorescent light is shining onto the remote sensor.
- The receiver is located near a device that is emitting infrared rays.
- The receiver is operated simultaneously with another infrared remote control unit.

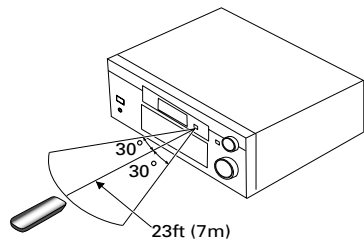

## Introduction to home theater

You are probably used to using stereo equipment to listen to music, but may not be used to home theater systems that give you many more options (such as surround sound) when listening to soundtracks.

Home theater refers to the use of multiple audio channels to create a surround sound effect, making you feel like you're in the middle of the action or concert. The surround sound you get from a home theater system depends not only on the speakers you have set up in your room, but also on the source and the sound settings of the receiver.

DVD-Video has become the basic source material for home theater due to its size, quality, and ease of use. Depending on the DVD, you can have up to seven different audio channels coming from one disc, all of them being sent to different speakers in your system. This is what creates a surround sound effect and gives you the feeling of 'being there'.

This receiver will automatically decode Dolby Digital, DTS, or Dolby Surround DVD-Video discs, according to your speaker setup. In most cases, you won't have to make changes for realistic surround sound, but other possibilities (like listening to a CD with multichannel surround sound) are explained in *Playing sources*, starting on page 30.

## Listening to Surround Sound

This receiver was designed with the easiest possible setup in mind, so with the following quick setup guide, you should have your system hooked up for surround sound in no time at all. In most cases, you can simply leave the receiver in the default settings.

### 1 Hook up your DVD player.

For surround sound, you'll want to hook up using a digital audio connection from the DVD player to the receiver. You can do this with either a coaxial, or an optical connection (you don't need to do both). If you hook up using an optical cable, you should refer to *Optical digital input setting* on page 41 to assign the optical input to DVD.

Use a video cord to connect the video output on your DVD player to the receiver using the jacks shown below.

### 2 Hook up your TV.

Use a video cord to connect your receiver to the TV using the jacks as shown below.

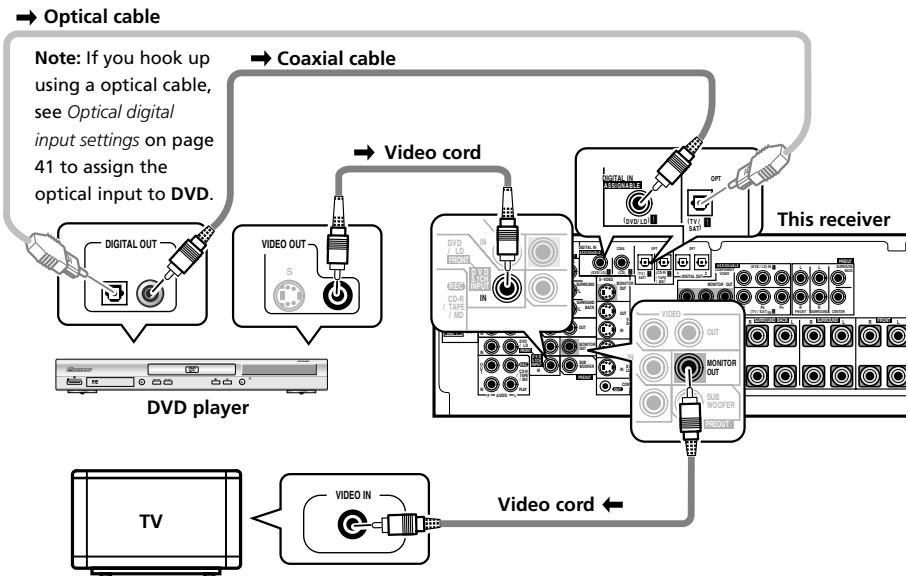



### 3 Connect your speakers.

A complete setup of eight speakers is shown here (including the subwoofer) but everyone's home setup will vary. Simply connect the speakers you have in the manner shown below. The receiver will work with just two stereo speakers (the front speakers in the diagram) but using at least three speakers is recommended, and a complete setup is best.

Make sure you connect the speaker on the right to the right terminal and the speaker on the left to the left terminal. Also make sure the positive and negative (+/-) terminals on the receiver match those on the speakers.

#### Note

- Use speakers with a nominal impedance of 8  $\Omega$  to 16  $\Omega$ .
- If you're not using a subwoofer, change the front speaker setting (see *Speaker setting* on page 37) to large
- When using the speaker on your TV as the center speaker (C), connect the **CENTER PREOUT** jack on this unit to the audio input jack on your TV. In this case the center speaker shown is unnecessary.

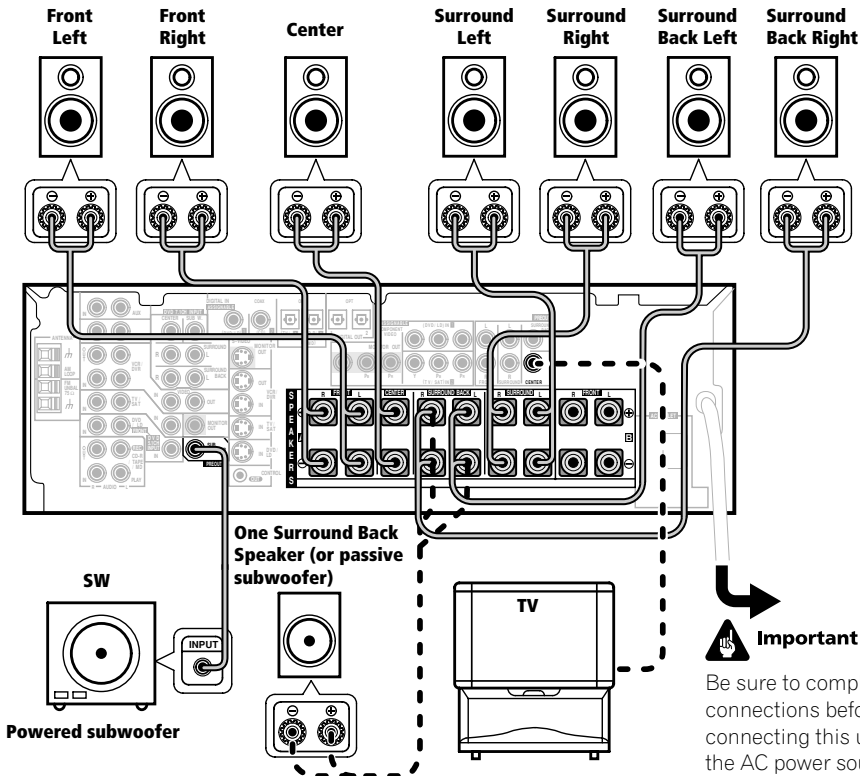

If you only have one surround back speaker connect as below. You could also use this method for a subwoofer when using the surround back speaker terminal for a passive subwoofer.

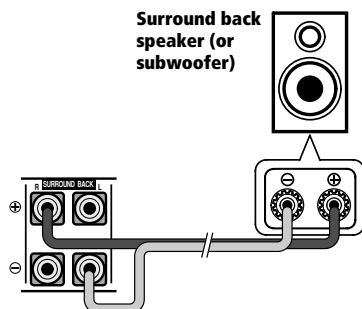

#### Note

- Be sure to complete all connections before connecting this unit to the AC power source.
- If you are using only one surround back speaker, connect the positive wire to the right channel (+) terminal, and the negative wire to the left channel (-) terminal (shown above).
- If you select subwoofer (**SB SUBWF**) in the *Surround back speaker setting* (see page 37) you can hook up a subwoofer instead of speakers to the surround back speaker terminals. Connect the wires just as above, connecting the positive wire to the right channel (+) terminal, and the negative wire to the left channel (-) terminal.

**4 Plug in the receiver and switch it on, followed by your DVD player, your subwoofer and the TV.**

Make sure you've set the video input on your TV to this receiver. Check the manual that came with the TV if you don't know how to do this.

Also make sure that **DVD/LD** is showing in the receiver's display, indicating that the DVD input is selected. If it isn't, press **DVD/LD** on the remote control to set the receiver to the DVD input.

**5 Press QUICK SETUP on the front panel to specify your speaker setup and your room size.**

Use the **MULTI JOG/INPUT SELECTOR** dial to select and **ENTER** to confirm your selection. See *Using the Quick Setup* on the next page if you're unsure about the settings.

**6 Play a DVD, and adjust the volume to your liking.**

There are several other sound options you can select. See pages 30–31 for more on this. See also *Choosing your receiver setup* on page 36–42 for more setup options.

**Note**

Depending on your DVD player or source discs, you may only get digital 2 channel stereo and analog sound. In this case, the listening mode must be set to Standard (it should already be set—see page 32–33 if you need to do this) if you want multichannel surround sound.

## Using the Quick Setup

You can use the Quick Setup to get your system up and running with just a few button presses. The receiver automatically makes the necessary settings after you have selected your speaker setup and room size. If you want to make more specific settings, refer to *Choosing your receiver setup* on pages 36–42. Use the front panel controls for the steps below.

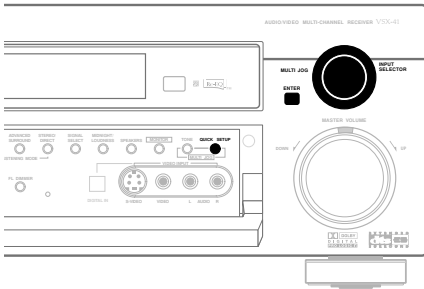

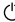
**1 If the receiver is off, press  STANDBY/ON to turn the power on.**

The **STANDBY** indicator goes out.

**2 Press QUICK SETUP.**

The display prompts you to select your speaker setup.

**3 Use the MULTI JOG/INPUT SELECTOR dial to choose your speaker setup.**

Cycle between the following choices:

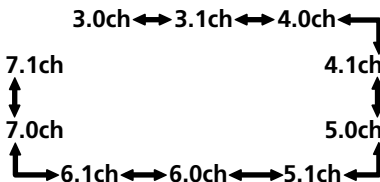

### Note

Check the table below to find the speaker setup that corresponds with your system.

	Front Speakers	Center Speaker	Surround Speakers	Surround Back Sp.	Sub Woofer
<b>3.0 ch</b>	✓	✓			
<b>3.1 ch</b>	✓	✓			✓
<b>4.0 ch</b>	✓		✓		
<b>4.1 ch</b>	✓		✓		✓
<b>5.0 ch</b>	✓	✓	✓		
<b>5.1 ch</b>	✓	✓	✓		✓
<b>6.0 ch</b>	✓	✓	✓	(1 speaker)	
<b>6.1 ch</b>	✓	✓	✓	(1 speaker)	✓
<b>7.0 ch</b>	✓	✓	✓	(2 speakers)	
<b>7.1 ch</b>	✓	✓	✓	(2 speakers)	✓

**4 Press ENTER.**

The display prompts you to select your room size.

**5 Use the MULTI JOG/INPUT SELECTOR dial to choose your room size.**

Depending on the distance of your speakers from the listening position, choose between Small, Medium, or Large (see table below).

	S	M	L
<b>Front</b>	12 ft.	12 ft.	12 ft.
<b>Center</b>	10 ft.	10 ft.	10 ft.
<b>Surround</b>	6 ft.	7 ft.	9 ft.
<b>Surround Back</b>	3 ft.	5 ft.	7 ft.

**6 Press ENTER to confirm your setup.**

The display shows the speaker setup and room size that you have selected.

*Before making or changing any connections, switch off the power and disconnect the power cord from the AC wall outlet.*

## Audio/Video cords

Use audio/video cords (not supplied) to connect the audio/video components and a video cord to connect the monitor TV.

Connect red plugs to **R** (right), white plugs to **L** (left), and the yellow plugs to **VIDEO**.

Be sure to insert completely.

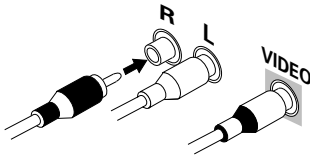

## S-video cables

Use S-video cables (not supplied) to get clearer picture reproduction than regular video cords.

Connect from an S-video jack on the rear of the receiver to an S-video jack on the video component you are hooking up.

Be sure to insert completely.

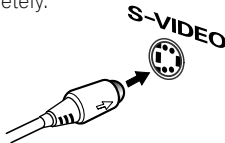

## Component video cords

Use component video cords to get the best possible color reproduction of your video source. The color signal of the TV is divided into the luminance (Y) signal and the color (PB and PR) signals and then output. In this way, interference between the signals is avoided. Connect from the component video jacks on the rear of the receiver to the component video jacks on the video component you are hooking up.

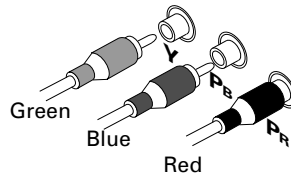

## Digital audio coaxial cords/ Optical cables

Commercially available digital audio coaxial cords (standard video cords can also be used) or optical cables (not supplied) are used to connect digital components to this receiver.

Be sure to insert completely.

**Digital audio coaxial cord  
(or standard video cord)**

**Optical cable**

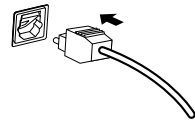
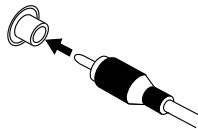

## Connecting digital components

The easiest way to hook up this receiver for surround sound is to use a digital input. You can do this by either coaxial or optical connections (you do not need to do both). The quality of these two types of connections is the same but since some digital components only have one type of digital terminal, it is a matter of matching like with like (for example, the coaxial output from the component to coaxial input on the receiver). The VSX-41 has four digital inputs (two coaxial inputs and two optical inputs). Connect your digital components to the rear panel as shown below. See page 17 to connect the front panel optical input.

There are two digital output jacks which is marked **DIGITAL OUT**. If you connect this to the optical input on a digital recorder (currently these include MD, DAT and CD-R) you can make direct digital recordings with this unit.

When connecting your equipment, always make sure the power is turned off and the power cord is disconnected from the AC wall outlet.

### Note

The arrows indicate the direction of the audio signal.

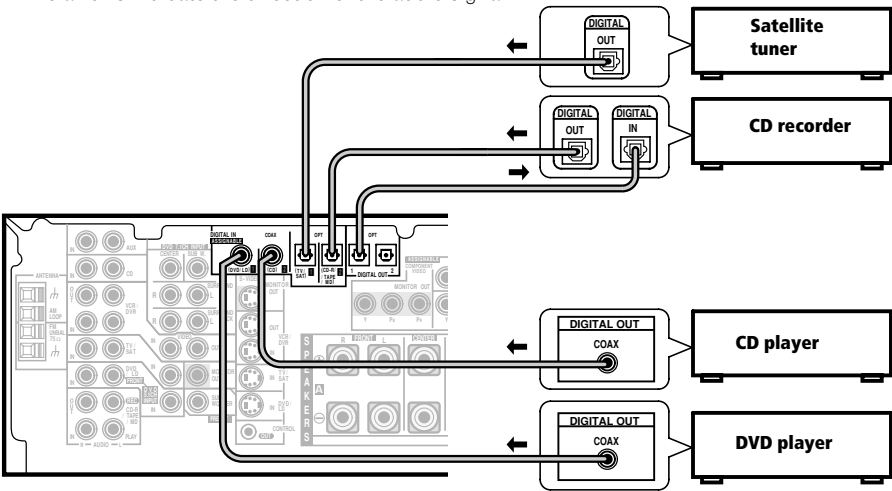

### Note

If you have an LD player, you need to make special connections to ensure you can play **DD** RF format LDs on your system. If this is the case, hook up your DVD/LD or LD player directly to an RF demodulator using both the **DD** RF output and either a coaxial or optical digital connection. We also recommend hooking up your digital components to analog audio jacks as well. Make sure the RF demodulator digital in switch is set correctly (optical or coaxial depending on the connection). See the component's instruction manual if you are unsure about its input and output jacks.



## Connecting DVD 7.1 channel components

If you prefer to use a separate component for decoding DVDs, you can connect a decoder or a DVD player with multichannel analog outputs to the multichannel inputs of this receiver.

When connecting your equipment, always make sure the power is turned off and the power cord is disconnected from the AC wall outlet.



### Note

The arrows indicate the direction of the signal.

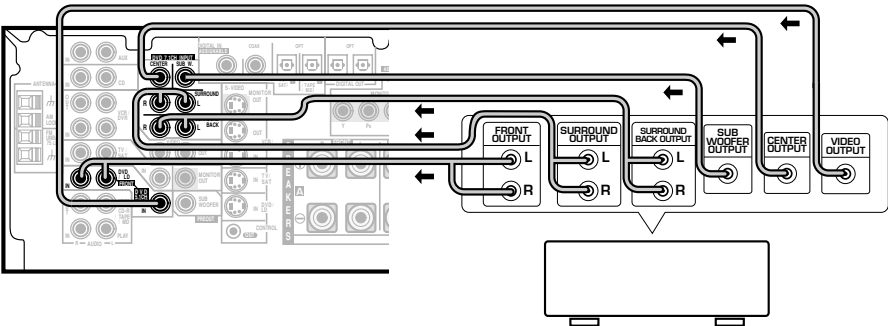

**DVD/multichannel decoder with  
7.1 channel analog output jacks**



### Note

- The multichannel input can only be used when **DVD 7.1 CH** is selected (see page 35).
- If the component you are connecting only has one surround back channel output, change the *Surround back channel input setting* (page 40) to **SB 1ch IN**.

## Connecting video components

Connect your video components to the jacks as shown below. With digital video components (like a DVD player), you must use one of the connections shown on the next page for the video signal, but in order to hear a digital source (like a DVD) you should hook up the audio to a digital input (see page 14). It is also a good idea to hook up your digital components with analog audio connections (see page 15).

For better quality video, you can hook up using the component video jacks or the S-video jacks (quality descends in this order) on the rear of the receiver instead of the regular video jacks (see the second illustration of the following page). Make sure they are connected to the video component using the same kind of connection. However, you don't need to make more than one type of video connection.

When connecting your equipment, always make sure the power is turned off and the power cord is disconnected from the AC wall outlet.



 **Note**

The arrows indicate the direction of the signal.

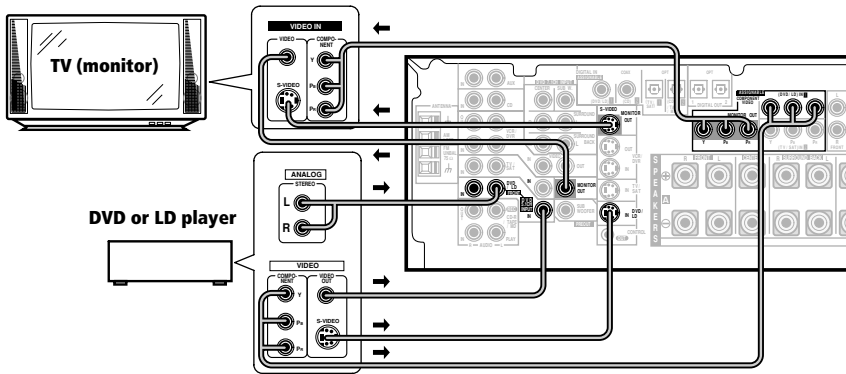
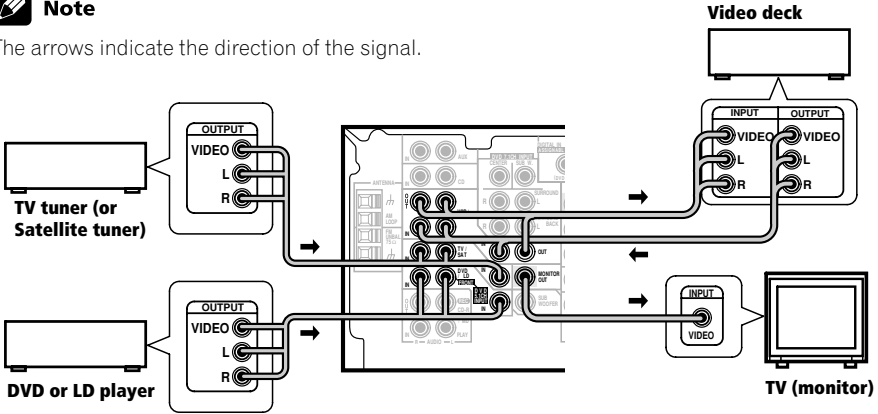

## Connecting to the front panel video terminal

Front video connections are accessed via the front panel input selector as **VIDEO**. There are standard audio/video jacks as well as an S-video jack and an optical input jack. Hook them up the same way you made the rear panel connections.

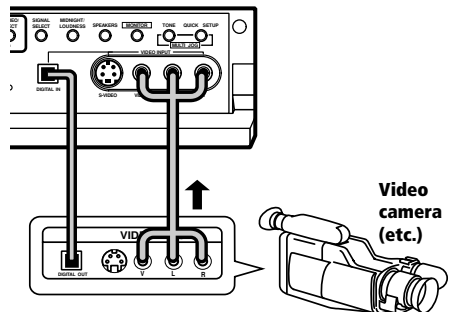

## Connecting antennas

Connect the AM loop antenna and the FM wire antenna as shown below. To improve reception and sound quality, connect external antennas (see *Using external antennas* below). Always make sure that the receiver is switched off and unplugged from the wall outlet before making or changing any connections.

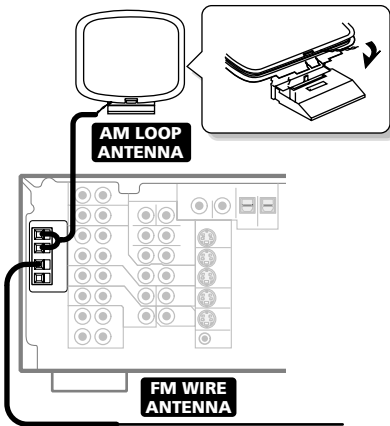

## FM wire antenna

Connect the FM wire antenna and fully extend vertically along a window frame or other suitable area, etc.

## AM loop antenna

Assemble the antenna and connect to the receiver. Attach to a wall, etc. (if desired) and face in the direction that gives the best reception.

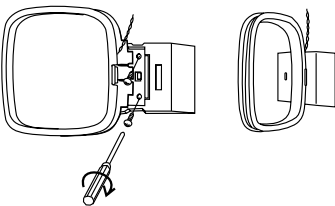

## Antenna snap connectors

Twist the exposed wire strands together and insert into the hole, then snap the connector shut.

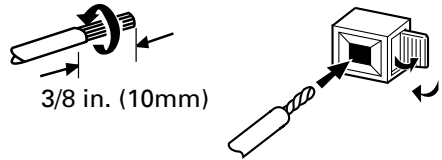

## Using external antennas

### To improve FM reception

Connect an external FM antenna.

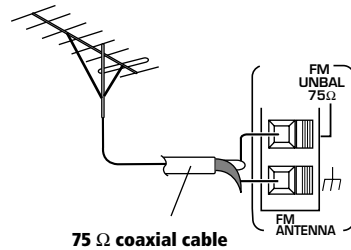

### To improve AM reception

Connect a 15-18 feet length of vinyl-coated wire to the AM antenna terminal without disconnecting the supplied AM loop antenna.

For the best possible reception, suspend horizontally outdoors.

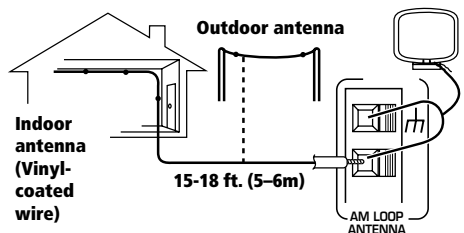

## Connecting the speakers

A complete setup of eight speakers (including the subwoofer) is shown below, but everyone's home setup will vary. Simply connect the speakers you have in the manner shown below. The receiver will work with just two stereo speakers (the front speakers in the diagram) but using at least three speakers is recommended, and a complete setup is best for surround sound. If you're not using a subwoofer, change the front speaker setting (see *Speaker setting* on page 37) to large.

Make sure you connect the speaker on the right to the right terminal and the speaker on the left to the left terminal. Also make sure the positive and negative (+/-) terminals on the receiver match those on the speakers.

### Note

Use speakers with a nominal impedance of 8 Ω to 16 Ω.

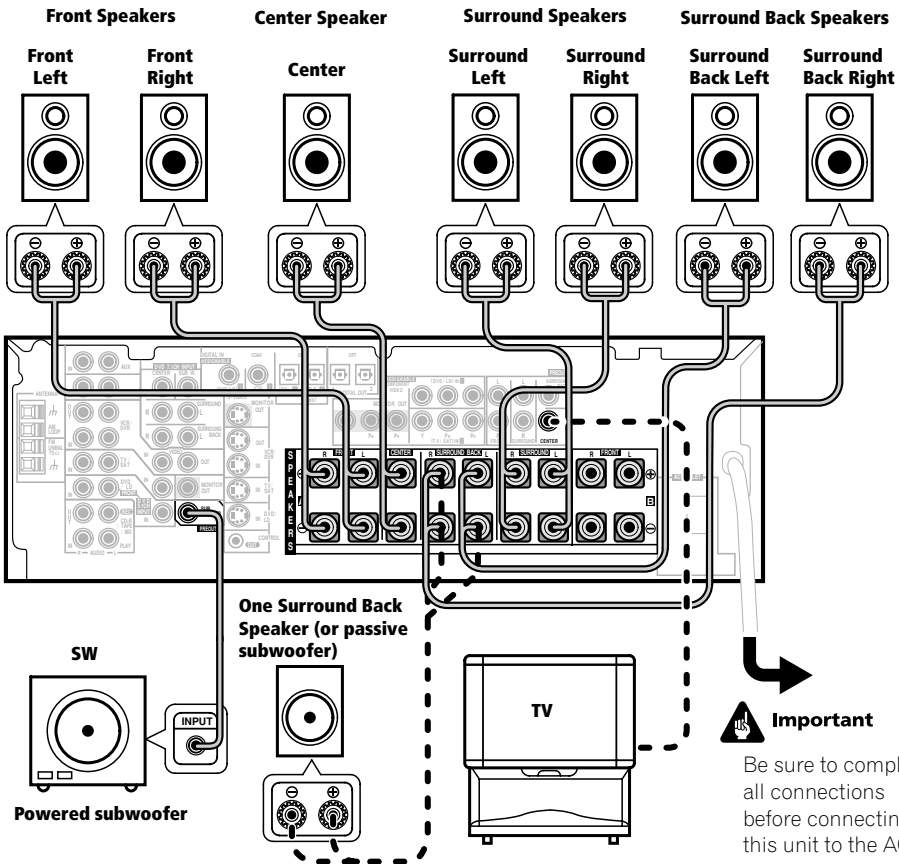

### Important

Be sure to complete all connections before connecting this unit to the AC power source.

**Note**

- When using the speaker on your TV as the center speaker (**C**), connect the **CENTER PREOUT** jack on this unit to the audio input jack on your TV. In this case the center speaker shown is unnecessary.
- If you are using only one surround back speaker, connect the positive wire to the right channel (+) terminal, and the negative wire to the left channel (-) terminal (see illustration on page 10).
- If you select subwoofer (**SB SUBWF**) in the *Surround back speaker setting* (see page 37) you can hook up a subwoofer instead of speakers to the surround back speaker terminals. Connect the positive wire to the right channel (+) terminal, and the negative wire to the left channel (-) terminal (see illustration on page 10).

**Speaker terminals**

- 1 **Twist exposed wire strands together.**
- 2 **Loosen speaker terminal and insert exposed wire.**
- 3 **Tighten terminal.**

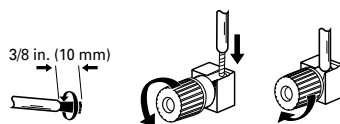

The speaker terminals also accept single banana plugs. (Refer to speaker manual for details.)

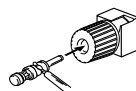
**Caution**

Make sure that all the bare speaker wire is twisted together and inserted fully into the speaker terminal. If any of the bare speaker wire touches the back panel it may cause the power to cut off as a safety measure. Use good quality speaker wire to connect the speakers to the receiver.

**A and B speaker systems**

The receiver has two speaker systems: A and B. A is the main system supporting the full speaker setup. If you switch on both A and B speaker systems, only the front speakers and the subwoofer will be audible. No sound will come from the center, surround, or surround back speakers, but multichannel sources will be down-mixed to the active speakers so no sound will be lost. Similarly, if you choose just the B system you'll only hear the front speakers connected to the B system and multi channel sources will be down-mixed to these two speakers.

**Hints on speaker placement**

Speakers are usually designed with a particular placement in mind. Some are designed to be floorstanding, while others should be placed on stands to sound their best. Some should be placed near a wall; others should be placed away from walls. We have provided a few tips on getting the best sound from your speakers (below), but you should also follow the guidelines on placement that the speaker manufacturer provided with your particular speakers to get the most out of them.

- Place the front left and right speakers at equal distances from the TV.
- When placing speakers near the TV, we recommend using magnetically shielded speakers to prevent possible interference, such as discoloration of the picture when the TV is switched on. If you do not have magnetically shielded speakers and notice discoloration of the TV picture, move the speakers farther away from the TV.

- Place the center speaker above or below the TV so that the sound of the center channel is localized at the TV screen.



### Caution

If you choose to install the center speaker on top of the TV, be sure to secure it with putty, or by other suitable means, to reduce the risk of damage or injury resulting from the speaker falling from the TV in the event of external shocks such as earthquakes.

- If possible, place the surround speakers slightly above ear level.
- Try not to place the surround speakers further away from the listening position than the front and center speakers. Doing so can weaken the surround sound effect.
- To achieve the best possible surround sound, install your speakers as shown below. Be sure all speakers are installed securely to prevent accidents and improve sound quality.

### Overhead view of speaker set up

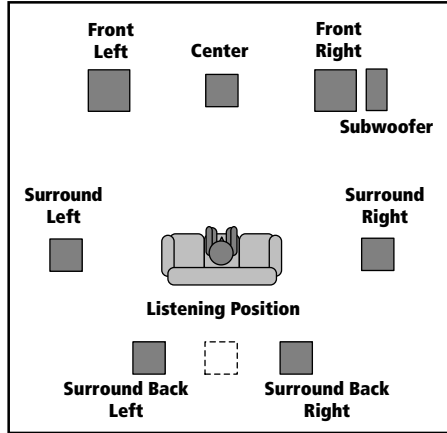

### 3-D view of speaker set up

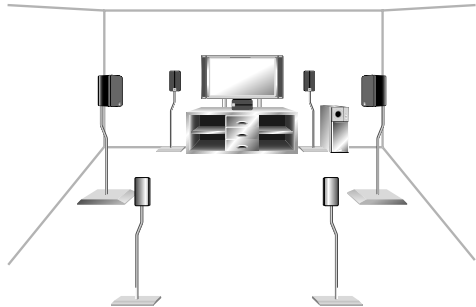

## Connecting additional amplifiers

This receiver has more than sufficient power for any home use, however it is possible to add additional amplifiers to every channel. Make the connections shown below to add amplifiers to power your speakers. Always make sure that the receiver is switched off and unplugged from the wall outlet before making or changing any connections.



### Note

The arrows indicate the direction of the audio signal.

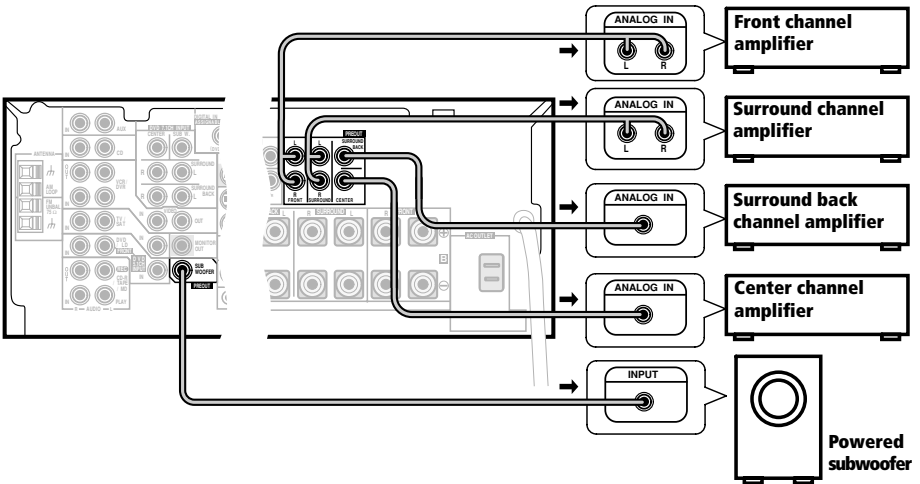

### Note

- To hear sound only from the pre-outs, disconnect any speakers that are connected directly to the receiver.
- If you're not using a subwoofer, change the front speaker setting (see *Speaker setting* on page 37) to large.

## AC wall outlet

[switched 100 W (0.8 A) max]

Power supplied through this outlet is turned on and off by the receiver's **POWER** switch. Total electrical power consumption of connected equipment should not exceed 100 W (0.8 A).

### Caution

**DO NOT CONNECT A MONITOR, TV SET, HEATER, OR SIMILAR APPLIANCE TO THIS UNIT'S AC WALL OUTLET.**

Do not connect appliances with high power consumption to the **AC WALL OUTLET** in order to avoid overheating and fire risk. This can also cause the receiver to malfunction.

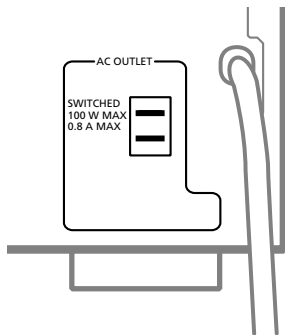

### Note

- Make sure no exposed speaker wire is touching the rear panel, this may cause the receiver to turn off automatically.
- This unit should be disconnected by removing the power plug from the wall socket when not in regular use (ex. when on vacation).

## POWER-CORD CAUTION

Handle the power cord by the plug. Do not pull out the plug by tugging the cord and never touch the power cord when your hands are wet as this could cause a short circuit or an electric shock. Do not place the unit, a piece of furniture, etc., on the power cord, or pinch the cord. Never make a knot in the cord or tie it with other cords. The power cords should be routed such that they are not likely to be stepped on. A damaged power cord can cause a fire or give you an electrical shock. Check the power cord once in a while. When you find it damaged, ask your nearest Pioneer authorized service center or your dealer for a replacement.

## Operating other Pioneer components

By connecting a control cord (optional), you can point the remote controls of other Pioneer components at the receiver's remote sensor. The remote control signals are received by the remote sensor of this unit, and sent to the other devices via the **CONTROL OUT** terminal.

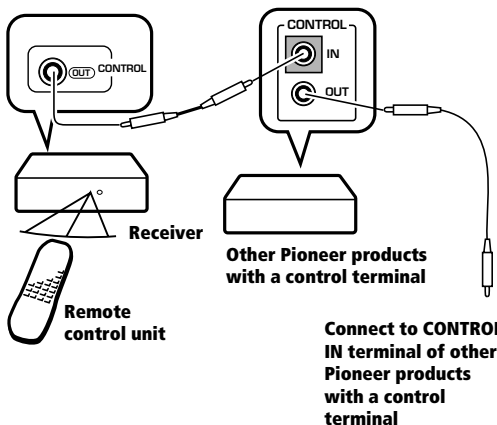

## Front panel

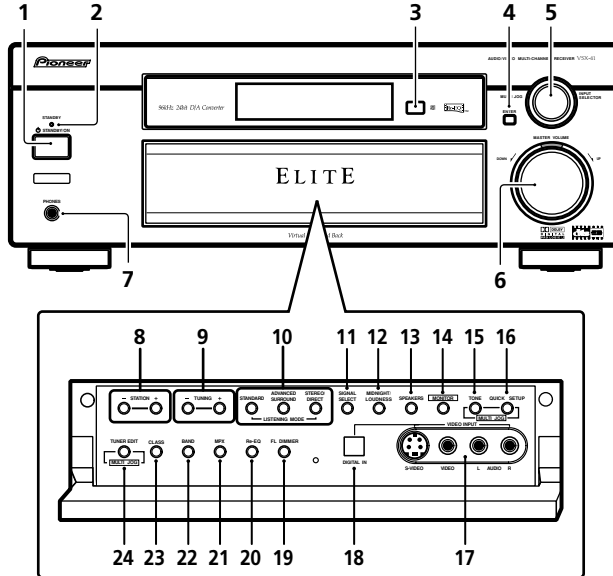

- 1** **STANDBY/ON**  
Switches the receiver between on and standby.
- 2** **STANDBY indicator**  
Lights when the receiver is in standby.
- 3** **Remote sensor**  
Receives the signals from the remote control.
- 4** **ENTER button**
- 5** **MULTI JOG/INPUT SELECTOR dial**  
The **MULTI JOG/INPUT SELECTOR** dial performs a number of tasks. Use it to select options after pressing **TONE CONTROL**, **QUICK SETUP** or **TUNER EDIT**.
- 6** **MASTER VOLUME**
- 7** **PHONES jack**  
Use to connect headphones. When the headphones are connected, there is no sound output from the speakers.
- 8** **STATION (+/-) buttons** (pages 44–45)  
Selects station presets or characters for those presets when using the tuner.
- 9** **TUNING buttons** (page 43)  
Selects the frequency when using the tuner.
- 10** **LISTENING MODE buttons**  
**STANDARD** (pages 30, 32,33)  
Press for Standard decoding and to switch between the various Pro Logic II options.  
**ADVANCED SURROUND** (pages 31, 33)  
Use to switch between the various surround modes.  
**STEREO/DIRECT** (pages 30, 33)  
Switches direct playback on or off. This bypasses the tone controls and channel levels for the most accurate reproduction of a source.
- 11** **SIGNAL SELECT**
- 12** **MEMORY/TUNING**
- 13** **PRESET**
- 14** **RECALL**
- 15** **TONE**
- 16** **QUICK SETUP**
- 17** **VIDEO**
- 18** **PHONES**
- 19** **FL DIMMER**
- 20** **FM-EG**
- 21** **MPX**
- 22** **BAND**
- 23** **CLASS**
- 24** **TUNER EDIT**



## 11 SIGNAL SELECT (pages 32, 35, 46)

Use to select an input signal.

## 12 MIDNIGHT/LOUDNESS (page 33)

Use Midnight when listening to movie soundtracks at low volume. Use Loudness to boost the bass and treble at low volume.

## 13 SPEAKERS

Use to cycle through the speaker system: **A** → **B** → **A+B**

## 14 MONITOR

Press to switch tape monitoring on/off.

## 15 TONE

Press this button to access the bass and treble controls, which you can then adjust with the **MULTI JOG/INPUT SELECTOR dial**.

## 16 QUICK SETUP

## 17 VIDEO INPUT (page 17)

## 18 DIGITAL IN (page 17)

## 19 FL DIMMER

Use this button to make the fluorescent display (FL) dimmer or brighter.

## 20 Re-EQ (page 41)

This feature compensates for the effect of reproducing sounds that have been originally processed for a large movie theater in a smaller room.

## 21 MPX (page 43)

Press to receive a radio broadcast in mono.

## 22 BAND (page 43)

Switches between AM and FM radio bands.

## 23 CLASS (pages 44–45)

Switches between the three banks (classes) of station presets.

## 24 TUNER EDIT (pages 44–45)

Press to memorize and name a station for recall using the **STATION +/-** buttons or the **MULTI JOG/INPUT SELECTOR dial**.

## Display

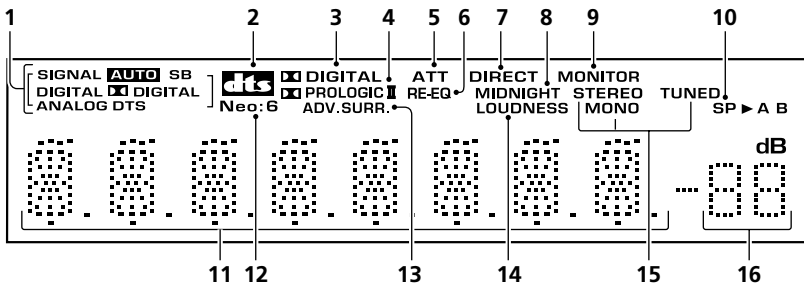

## 1 SIGNAL SELECT indicators

Lights to indicate the type of input signal assigned for the current component:

### AUTO

Lights when AUTO signal select is on

### SB

Depending on the source, this lights when a signal with surround back channel encoding is detected.

### DIGITAL

Lights when a digital audio signal is detected.

**DIGITAL**

Lights when a Dolby Digital signal is detected.

**ANALOG**

Lights when an analog signal is detected.

**DTS**

Lights when a source with DTS audio signals is detected.

**2 DTS**

When the Standard mode of the receiver is on, this lights to indicate decoding of a DTS signal.

**3 DIGITAL**

When the Standard mode of the receiver is on, this lights to indicate decoding of a Dolby Digital signal.

**4 PRO LOGIC II**

When the Standard mode of the receiver is on, this lights to indicate Pro Logic II decoding.

**5 ATT**

Lights when INPUT ATT is used to attenuate (reduce) the level of the analog input signal.

**6 RE-EQ:**

Lights when Re-Equalization is switched on. This feature evens out the sound for smaller rooms.

**7 DIRECT**

Lights when source direct playback is in use. This function bypasses all tone, balance, Advanced Surround, and Dolby Surround effects.

**8 MIDNIGHT**

Lights during Midnight listening.

**9 MONITOR**

Lights when **MONITOR** is selected (page 46).

**10 Speaker indicator**

Shows the speaker system currently in use.

**11 Character display****12 Neo:6**

Lights during NEO:6 processing

**13 ADV. SURR (Advanced Surround)**

Lights when one of the Advanced Surround modes has been selected.

**14 LOUDNESS**

Lights when **LOUDNESS** has been selected.

**15 TUNER indicators****STEREO:**

Lights when a stereo FM broadcast is being received in auto stereo mode.

**MONO:**

Lights when the mono mode is set using the **MPX** button.

**TUNED:**

Lights when a broadcast is being received.

**16 Master volume level**

Shows the overall volume level. **---dB** indicates the minimum level, and **-0dB** indicates the maximum level.

Depending on your level settings for each channel, the maximum level can range between **-10dB** and **-0dB**.

## Remote control

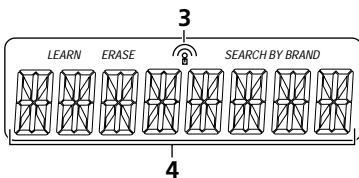
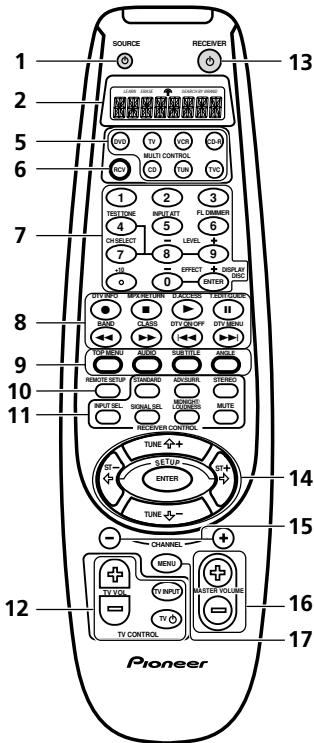

### 1 SOURCE

Press to turn on/off other components connected to the receiver.

### 2 LCD Screen

This screen displays the mode the receiver is in, commands sent, etc.

### 3 Transmit icon

Blinks to indicate the remote is transmitting control signals.

### 4 CHARACTER display (LCD)

Shows function modes and other information.

### SETUP

Indicates that the remote is in Setup mode so that new information (preset codes, learning, etc.) can be input (see pages 47–51).

### DIR SET

Indicates that the remote is in Direct Setup mode so you can put it in **DIRECT FUNCTION** (see pages 47–51).

### BRAND

Indicates that the remote is in preset code Search by Brand mode to find the preset codes for your components by brand (see page 49).

### SEARCH

Indicates that the remote is in Preset Code Search mode to find the preset codes for your components (see page 48).

### LEARN

Indicates that the remote is in Learning mode and ready to learn signals from other remote controls (see page 49).

### ERASE

Indicates that the remote is in Erase mode so that you can erase one or more learned buttons. (see page 50).

### RESET

Indicates that the remote is in Reset mode so that you can return it to default settings (see page 50).

### READ ID

Indicates that the remote is in Read ID mode so that you can check the preset codes (see page 51).

**5 MULTI CONTROL buttons**

Press to select control of other components (see *Controlling the Rest of Your System* on pages 47–51).

**6 RCV**

Switches the remote to controls the receiver (used to select the features above the number buttons. (ex. **INPUT ATT**, **FL DIMMER**)). Also use this button to set up surround sound (page 36, 42).

**7 Number buttons/Receiver controls/ ENTER**

Use the number buttons to directly select a radio frequency (page 43) or the tracks on a CD, DVD, etc.

**DISPLAY/ DISC (ENTER)**

The button's use depends on the component selected. It can be used to switch the display between the station preset name and the frequency for the tuner, enter commands for TV or DTV, and can also be used to select a disc in a multi-CD player.

**Receiver Controls**

Press the **RCV** button first to access the functions above the number buttons. The display flashes when it isn't possible to use a function.

**TEST TONE** (page 42)

Sounds the test tone when setting up the surround sound of the receiver.

**INPUT ATT**

Attenuates (lowers) the level of an analog input signal to prevent distortion (when the overload indicator lights).

**FL DIMMER**

Dims or brightens the display.

**CH SELECT** (page 42)

Selects a speaker when setting up the surround sound of the receiver.

**LEVEL +/-** (page 42)

Adjusts the levels of the surround sound of the receiver.

**EFFECT +/- buttons** (page 33)

Adds or subtracts the amount of effect with different advanced listening modes (except 5 or 6 Ch Stereo and Virtual SB).

**8 Component/Tuner controls**

The main buttons (▶, ■, etc.) are used to control a component after you have selected it using the **MULTI CONTROL** buttons. The tuner/DTV controls above these buttons can be accessed after you have selected the corresponding **MULTI CONTROL** button (**TUNER** or **DVD** (when connected to DTV)).

**DTV INFO**

Use to bring up information screens on a digital TV.

**MPX/RETURN** (page 43)

Switches between stereo and mono reception of FM broadcasts. If the signal is weak then switching to mono will improve the sound quality. Also acts as a stop button for CDs, tapes, or DVDs.

**D. ACCESS** (page 43)

After pressing, you can access a radio station directly using the number buttons.

**T. EDIT/GUIDE** (pages 44–45)

Press to memorize and name a station for recall using the **STATION +/-** buttons or the **MULTI JOG/ INPUT SELECTOR** dial. Also displays the guides on a digital TV.

**BAND** (page 43)

Switches between the tuner AM and FM bands.

**CLASS** (pages 44–45)

Switches between the three banks (classes) of radio station presets.

**DTV ON/OFF**

Switches a digital TV on/off.

## DTV MENU

Displays menus on a digital TV.

## 9 DVD controls (Press DVD first to access)

These controls will also function as DTV controls, depending on the component you've selected.

### TOP MENU

Displays the disc 'top' menu of a DVD.

### AUDIO

Changes the audio language or channel.

### SUBTITLE

Displays/changes the subtitles included in multilingual DVD-Video discs.

### ANGLE

Switches camera angles on discs with multi-angle scenes.

## 10 REMOTE SETUP (pages 47–51)

Press this button to set up the remote control to control other components.

## 11 RECEIVER CONTROL buttons

### STANDARD (pages 30, 32–33)

Press to switch between the various Dolby/DTS modes

### ADV. SURR. (pages 31, 33)

Use to switch between the various surround modes.

### STEREO (pages 30, 33)

Switches direct playback on or off. This bypasses the tone controls and channel levels for the most accurate reproduction of a source.

### INPUT SELECT

Use to select the input source.

### SIGNAL SELECT (pages 32, 35, 46)

Use to select an input signal.

## MIDNIGHT/LOUDNESS (page 33)

Switches to Midnight or Loudness listening.

## MUTE

Mutes the sound (or restores the sound if it has been muted).

## 12 TV control buttons

These buttons can only be used to control your TV.

### TV VOLUME +/-

Use to adjust the volume on your TV.

### TV INPUT

Use select the TV function.

### TV

Use to turn on/off the power of the TV.

## 13 RECEIVER

This switches between standby and on for this receiver.

## 14 (TUNE/ST +/-) /ENTER

Use the arrow buttons when setting up your surround sound system (see pages 36–41). Also used to control DVD menus/options and for deck 1 of a double cassette deck player. Use the **TUNE +/-** buttons to find radio frequencies and use **ST +/-** to find and name preset stations (page 43–45).

## 15 CHANNEL +/-

Select radio station presets. Also skip tracks backward or forward on CDs, DVDs, etc.

## 16 MASTER VOLUME +/-

Use to set the listening volume.

## 17 MENU button

Displays the disc menu of DVD-Video discs. It also displays TV and DTV menus.

## Introduction to Sound Modes

There are three basic sound options: Stereo/Direct, Standard or Advanced Surround.

### Stereo/Direct

When you select **STEREO** or **DIRECT**, you will hear the source through just the front left and right speakers (and possibly your subwoofer depending on your speaker settings). Dolby Digital and DTS multichannel sources are downmixed to stereo.

In **STEREO**, you'll hear the audio with your surround settings and you can still use the Midnight, Loudness, and Tone control functions.

With **DIRECT**, you will bypass all effects and surround settings so that the audio remains as close to the source audio signal as possible.



#### Note

If you switch on Midnight listening, Loudness, or the Tone controls when **DIRECT** is selected, the receiver automatically switches to **STEREO**.

### Standard mode

The standard mode can be used to decode Dolby Digital, DTS, or Dolby Surround sources. The other surround sound options (next column) can add multichannel sound to regular stereo sources. If you play a Dolby Digital or DTS source the receiver will change to that mode automatically.

You can identify Dolby Digital software by the



marks. Most Dolby Surround software is marked (DOLBY SURROUND), but unmarked software may also incorporate Dolby Surround. Depending on the source, the *6.1 channel setting* (page 38), and the sound mode you have selected, you may not get sound from

the surround back speakers in your setup. For more on this, refer to the table on the next page.

Choose one of the following to add depth to a 2 channel source:

### Pro Logic

This mode gives 4.1 channel surround sound. It is less sensitive to the quality of the source material, so may be useful when Pro Logic II Movie/ Music modes don't give good results.

### Pro Logic II Movie

This mode gives 5.1 channel surround sound. It is suitable for movies, especially those recorded in Dolby Surround. The channel separation and movement of surround effects is comparable to Dolby Digital 5.1.

### Pro Logic II Music

This mode gives 5.1 channel surround sound and is suitable for music. The surround effect is more enveloping than Pro Logic II Movie.

### Neo:6 Cinema

This mode gives 6.1 channel surround sound and is suitable for movies. The Neo:6 Cinema mode delivers good channel separation for movie soundtracks.

### Neo:6 Music

This mode gives 6.1 channel surround sound and is suitable for music. The Neo:6 Music mode plays the stereo source as is through the front left/right speakers, and generates a natural, ambient surround and center sound.

## Advanced Surround modes

These are designed to be used with multichannel surround sound audio/video sources (like DVDs and LDs). Most Advanced Surround modes are designed to be used with film soundtracks, but some modes are also suited for music sources. Try different settings with various soundtracks to see which you like.



### Note

Depending on the source, the 6.1 channel setting (page 40), and the sound mode you have selected, you may not get sound from the surround back speakers in your setup. For more on this, refer to the table below.

## Movie

Simulates the relaxed environment of a movie theater, and is suitable for watching movies.

## Music

Simulates the acoustic environment of a large concert hall and is suitable for music or musical sources.

## Virtual Surround Back (VIRT SB)

The Virtual Surround Back effect simulates 7.1 surround channel listening (like Dolby Digital Surround EX or DTS-EX), giving the impression that there are two surround back speakers in your system when listening to a 5.1 channel source.

## Expanded

This mode is especially designed to give sound depth to stereo sources, and lets you hear two-channel (stereo) signals as simulated multichannel surround sound. Use with Dolby Pro Logic for a stereo surround effect. You can also use with Dolby Digital sources for a wider stereo field than the Standard modes.

## 6-Channel Stereo

This can be selected to give multichannel sound to a stereo source, using all of the speakers in your setup.

Type of source	6.1 ch. setting	Standard	Advanced Movie/Music	Virtual SB	Expanded	6 Ch. Stereo
DTS-ES/Dolby Digital Surround EX encoded multi-channel sources with 6.1 surround	Auto	√	√		√	√
	Fix	√	√		√	√
Dolby Digital/DTS encoded multi-channel sources with stereo surround	Auto					√
	Fix	√	√		√	√
Dolby Digital/DTS encoded multi-channel sources with mono surround, Stereo sources	Auto					√
	Fix		√			√
Analog 2-channel (stereo) source	Auto					√
	Fix		√			√



### Note

- The check mark (√) indicates when sound will be output from the surround back speaker(s).
- See the *6.1 channel setting* on page 40 to select between **AUTO** or **FIX**.

## Choosing the input signal

You need to hook up a component to both analog and digital inputs on the rear of the receiver to select between input signals.

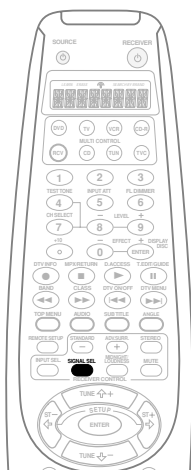

- Press **SIGNAL SEL (SIGNAL SELECT)** to select the input signal corresponding to the source component.

Each press switches between **AUTO**, **DVD 7.1ch**, **ANALOG** and **DIGITAL**. The default is **AUTO**.

**DVD 7.1ch** will only appear when **DVD/LD** is selected using the remote or the **MULTI JOG/INPUT SELECTOR** dial on the front panel.

When set to **DIGITAL**, **DD DIGITAL** lights when a Dolby Digital signal is input, and **DTS** lights when a DTS signal is input.

### Note

- This receiver can only play back Dolby Digital, PCM (32kHz, 44kHz, 48kHz, and 96 kHz) and DTS digital signal formats. With other digital signal formats, set to **ANALOG**.

- You may get digital noise when a LD or CD player compatible with DTS is playing an analog signal. To prevent noise, make the proper digital connections (page 14) and set the signal input to **DIGITAL**.

- Some DVD players don't output DTS signals. For more details, refer to the instruction manual supplied with your DVD player.

## Listening to multichannel playback

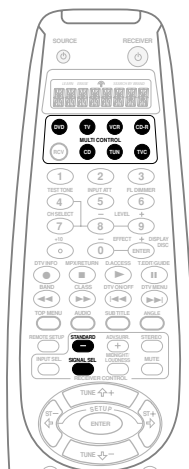

- 1 **Switch on the playback component.**
- 2 **Select the source you want to playback.** Use the **MULTI CONTROL** buttons on the remote (or **MULTI JOG/INPUT SELECTOR** dial on the front panel).

- 3 **Press STANDARD.** If the source is Dolby Digital, DTS, or Dolby Surround encoded, the proper decoding format will automatically be selected and shows in the display.



If you are listening to a two channel source, each press changes the display as follows:

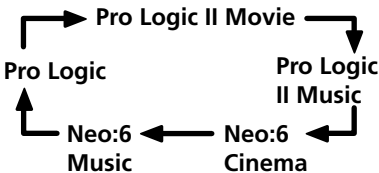

Refer to page 30 for more details about each mode.

**4 Start playback of the component you selected in step 1.**

## Using Stereo/Direct

When you select **STEREO** or **DIRECT**, you will hear the source through just the front left and right speakers (and possibly your subwoofer depending on your speaker settings). Dolby Digital and DTS multichannel sources are downmixed to stereo. See page 30 for more on these modes.

- Press **STEREO (STEREO/DIRECT on the front panel)** repeatedly to switch between the two options.



**Note**

If you switch on Midnight listening, Loudness, or the Tone controls when **DIRECT** is selected, the receiver automatically switches to **STEREO**.

## Using Advanced Surround

When you select one of the Advanced surround options, Dolby Pro Logic, Dolby Digital and DTS decoding is done automatically corresponding to the input signal. Use Advanced surround to add effects to the surround sound.

- Press **ADV.SURR. (ADVANCED SURROUND)** repeatedly to cycle the sound options.

Each press changes the display as follows:

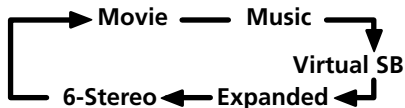

Refer to page 31 for more details about each surround effect.



**Note**

The Advanced surround effects can be adjusted in the range of 10 to 90 (the default setting is 70) by pressing **RCV** then pressing **EFFECT +/-**. The effect level can be set for each Advanced surround mode. The Standard mode cannot be changed.

## Using Loudness and Midnight listening

The Loudness listening feature can be used to get good bass and treble from music sources at low volume levels.

The Midnight listening feature allows you to hear effective surround sound of movies at low volume levels. The effect automatically adjusts according to the volume at which you're listening.

- Press **MIDNIGHT/LOUDNESS**. Each press cycles through the effects as follows:



## Using the tone controls

Depending on what you are listening to, you may want to adjust the bass or treble using the front panel tone control.

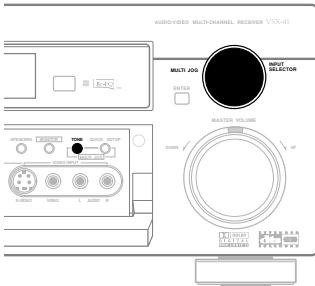

- 1 Press **TONE** to select the frequency you want to adjust.

Each press switches between **BASS** and **TREBLE**.

- 2 Use the **MULTI JOG/INPUT SELECTOR** dial to change the amount of bass or treble as necessary.

Wait about five seconds for your changes to be input automatically.

## Playing other sources

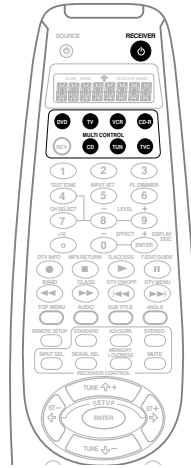

- 1 Turn on the power of the playback component.
- 2 Turn on the power of the receiver.
- 3 Select the source you want to playback. Use the **MULTI CONTROL** buttons on the remote (or **MULTI JOG/INPUT SELECTOR** dial on the front panel).
- 4 Start playback of the component you selected in step 1.

## Selecting the multichannel analog inputs

If you have connected a decoder or a DVD player with multichannel analog outputs to this receiver (page 16), you must select the analog multichannel inputs for surround sound playback.

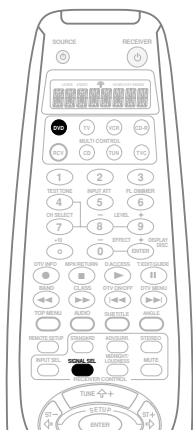

**1 Press DVD or select it with the MULTI JOG/INPUT SELECTOR dial (front panel).**

**2 Press SIGNAL SEL (SIGNAL SELECT) repeatedly to select DVD 7.1ch.**

To cancel playback from the multichannel inputs, use the **SIGNAL SEL (SIGNAL SELECT)** button to select a different input signal.

**Note**

- When playback from the multichannel inputs is selected, you can't use the **SPEAKER**, **INPUT ATT**, **TONE**, and **MIDNIGHT/LOUDNESS** buttons, as well as the Standard, Advanced Surround, and Stereo/Direct sound modes.
- When playback from the multichannel inputs is selected, only the volume and channel levels can be set.

## Using Re-Equalization

Re-equalization compensates for the effect of reproducing sounds in a smaller room that have been originally processed for a large movie theatre that can handle lots of high frequencies. Both the front and the center channels were originally mixed to give normal sound behind a heavy projection screen, and might sound unnaturally bright with a home theater setup. Use the Re-equalization feature to even out the sound if you feel that movie soundtracks are sounding slightly harsh.

- **Press the Re-EQ button on the front panel.**

The receiver automatically switches to Standard mode and Re-equalization is applied. Press Re-EQ again to switch Re-equalization off.

**Note**

- You can't use the **NEO:6 Music** and **Pro Logic II Music** modes when Re-equalization is on.
- If **STEREO** or one of the **Advanced Surround** modes is selected, Re-equalization is automatically cancelled. Selecting speaker system B will also cancel Re-equalization.
- Re-equalization is not applied to the headphone mix.

## Choosing your receiver setup

To ensure the best possible surround sound, be sure to complete the following set up operations. This is particularly important when using Dolby surround. You only need to make these settings once (unless you change the placement of your current speaker system or add new speakers, etc.). Refer to the following pages for details on each of the settings.

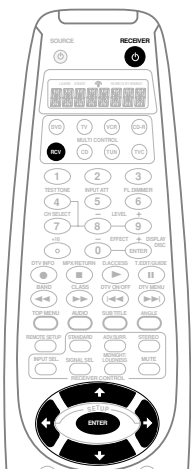

- 1 Press **RECEIVER** to turn the power on.

The **STANDBY** indicator goes out.

- 2 Press **RCV**.

- 3 Use **←** or **→** to choose the option you want to adjust.

It will be easiest to adjust each of the settings in turn, following the order below (and on the following pages). The current setting is shown for each option as you cycle through the display.

### Speaker setting (page 37)

Specify the number and type of speakers you have connected.

### Surround back speaker setting (page 37)

Specify your surround back speaker/surround back subwoofer setup.

### 6.1 channel setting (page 38)

Set when 6.1 channel decoding is used.

### Subwoofer setting (page 38)

Specify how the subwoofer is used.

### Crossover frequency setting (page 38)

Determine which frequencies will be sent to the subwoofer (or large speakers).

### LFE attenuator setting (page 39)

Specify the peak level for the LFE channel.

### Front speaker distance setting (page 39)

Specify the distance from your listening position to your front speakers.

### Center speaker distance setting (page 39)

Specifies the distance from your listening position to your center speaker.

### Surround speaker distance setting (page 39)

Specify the distance from your listening position to your surround speakers.

### Surround back speaker distance setting (page 39)

Specifies the distance from your listening position to your surround back speakers.

### Dynamic range control setting (page 40)

Compress the dynamic range of the sound track.

### Dual mono setting (page 40)

Isolate one channel when listening to discs with dual mono encoding.

## Component video input setting (page 40)

Specify the components to be assigned to the component video inputs (below).

- Component video 1 input setting
- Component video 2 input setting

## Surround back channel input setting (page 40)

Specify the number of surround back inputs you have connected.

## Digital input settings (page 41)

Specify the components to be assigned to the video and digital inputs (below).

- Coaxial digital input 1 setting
- Coaxial digital input 2 setting
- Optical digital input 1 setting
- Optical digital input 2 setting

**4 Use  $\uparrow$  or  $\downarrow$  to adjust the setting.**  
The setting is entered automatically.

**5 Repeat steps 3 and 4 to set other surround modes.**

**6 When you're done, press ENTER to exit.**



### Note

The setting display is automatically exited after 20 seconds of inactivity.

## Speaker setting

- Default setting: **S** (all speakers)

You must let the receiver know how many speakers you have, and how big they are. The size you choose (large or small) determines how much bass is sent from the receiver to the speakers.

In the display, **F**, **C**, and **S** refer to front, center, and surround speakers respectively. Speaker size is denoted as **L** for large speakers, **S** for small speakers, and **\*** (asterisk) if no speaker is connected.



### Note

- If the cone size (diameter) of the speaker is larger than 5 inches, set the speaker size to **L**.
- If you're not using a subwoofer, we recommend setting the front speakers to **L**.

**• Cycle through the available choices using  $\uparrow$  or  $\downarrow$  and choose a configuration that matches your speaker setup.**

One of the following configurations should match your setup:

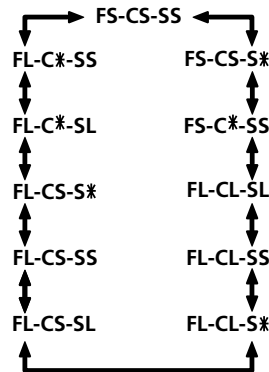

## Surround back speaker setting

- Default setting: **S**

You must let the receiver know if surround back speaker(s) have been connected, and how big they are. The size you choose (large or small) determines how much bass is sent from the receiver to the speakers. If you have connected a surround back subwoofer, you should select the surround back subwoofer setting (**SB SUBWF**) from the options. Choose **\*** (asterisk) if no speaker is connected.

**• Use  $\uparrow$  or  $\downarrow$  to select SB L, SB S, SB\* or SB SUBWF.**

## 6.1 channel setting

- Default setting: **6.1 FIX**

You can have the receiver automatically switch to Dolby Digital Surround EX or DTS-ES decoding for 6.1 encoded sources (**6.1 AUTO**), or you can choose to listen to other kinds of sources (for example, 5.1 encoded material) with 6.1 encoding (**6.1 FIX**). With 5.1 encoded sources, a surround back channel will be generated, but the material may sound better in the 5.1 format for which it was originally encoded.

- Use **↑** or **↓** to select **6.1 FIX** or **6.1 AUTO**.



### Note

- If you chose **SB\*** in Surround back speaker setting (above), you can't set the 6.1 channel setting and **\*\*\*** shows in the display.
- Refer to the table on page 31 to see how the *6.1 channel setting* affects sound output from the surround back speakers.

## Subwoofer setting

- Default setting: **ON**

You can choose whether the subwoofer is used or not. Use the plus (**PLS**) setting for extra bass.

- Use **↑** or **↓** to select subwoofer **ON**, **PLS** or **OFF**.



### Note

- If you chose the small front speaker setting, SUBWF ON is automatically set and locked.
- When you select the plus setting, you will get the bass sounds from the subwoofer even if the front speakers are set to **L**.

## Crossover frequency setting

- Default setting: **100 Hz**

Crossover frequency is the point where the receiver divides the high and low sounds (the frequencies) between the speakers. Since most smaller speakers can't handle deep bass tones, you can send these sounds to the subwoofer (or if you don't have a subwoofer, the large (**L**) speakers in your system) instead of the speakers set to small (**S**) in your setup. Choose the point at which you want the frequency routed to the subwoofer (or **L** speakers).

We recommend setting this to 200 Hz if your **S** speakers are smaller bookshelf-type speakers.

- Use **↑** or **↓** to specify the crossover frequency for your small speakers (**100 Hz**, **150 Hz** or **200 Hz**).

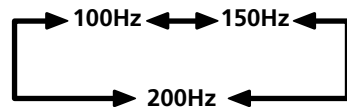

### 100 Hz

Sends bass frequencies below 100 Hz to the subwoofer (or **L** speakers).

### 150 Hz

Sends bass frequencies below 150 Hz to the subwoofer (or **L** speakers).

### 200 Hz

Sends bass frequencies below 200 Hz to the subwoofer (or **L** speakers).



### Note

If all speakers (front, center, and surround) are set to **L**, the crossover frequency can't be set because there are no **S** speakers (**\*\*\*** appears in the display).

## LFE attenuator setting

- Default setting: **0 dB**

Dolby Digital and DTS audio sources include ultra-low bass tones. Set the LFE attenuator as necessary to prevent the ultra-low bass tones from distorting the sound from the speakers.

- Use **↑** or **↓** to set the attenuation level (**0 dB**, **10 dB** or **\*\* dB(∞)**).

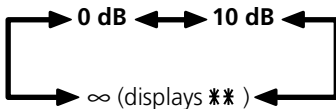

### Note

When **∞** is selected (**\*\*** appears in the display), LFE is not available.

## Front speaker distance setting

- Default setting: **10 ft.**

Sets the distance from the front speakers to the listening position.

- Use **↑** or **↓** to set the distance of the front speakers from the main listening position (within a 30 foot range).

## Center speaker distance setting

- Default setting: **10 ft.**

The center speaker is normally placed directly in the front of the listening room and closer to the listening position than the front speakers. This means that the sound from the center speaker will be heard before the front speakers. To prevent this, set the center speaker distance setting to delay the sound from the center speaker so that the sound from the front and center speakers will be heard at the same time.

- Use **↑** or **↓** to set the distance of the center speaker from the main listening position (within a 30 foot range).



### Note

When **C\*** is selected in the speaker setting, the center speaker distance can't be set.

## Surround speaker distance setting

- Default setting: **10 ft.**

Like the center speaker, you should set the distance of the surround speakers accurately to hear sounds coming from both front and surround speakers at the same time.

- Use **↑** or **↓** to set the distance of the surround speakers from the main listening position (within a 30 foot range).



### Note

When **S\*** is selected in the speaker setting, the surround speaker distance can't be set.

## Surround back speaker distance setting

- Default setting: **10 ft.**

Like the center speaker, you should set the distance of the surround speakers accurately to hear sounds coming from both front and surround speakers at the same time.

- Use **↑** or **↓** to set the distance of the surround speakers from the main listening position (within a 30 foot range).



### Note

When **SB\*** is selected in the surround speaker setting, the surround back speaker distance can't be set.

## Dynamic range control setting

- Default setting: **OFF**

Dynamic range is the difference between the loudest and softest sounds in any given signal. With this setting, you can compress the dynamic range, so that low level sounds can be heard more easily (sounding relatively louder) yet louder sounds won't be too overbearing.

- Press  $\uparrow$  or  $\downarrow$  to set the dynamic range control (**OFF**, **MAX**, or **MID**).



### Note

- When the volume level is increased, set to **OFF**.
- When listening at low volumes, set to **MAX** for maximum dynamic range compression.
- Dynamic range control is effective only when a Dolby Digital signal is being played back.

## Dual mono setting

- Default setting: **ch1**

The dual mono setting can only be used when listening to Dolby Digital discs with dual mono encoding. These discs are not widely used, but are sometimes used when it is necessary to have one language on one channel and a different language on the other. With this setting you can choose which channel in the dual mono setting you want to listen to.

You will hear the channel you have selected (either **ch1** or **ch2**) through your center speaker. If you don't have a center speaker, you will hear the channel you have selected through both front speakers. In the **L ch 1. R ch 2** setting, the left front speaker will play channel 1 and the right front speaker will play channel 2.

- Use  $\uparrow$  or  $\downarrow$  to cycle through the possible dual mono settings.

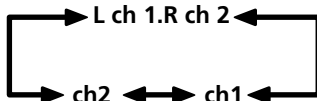

## Component video input settings

Here you tell the receiver what components you have hooked up to the component video jacks on the back of the receiver.

### Component video 1:

- Default settings: **DVD**

- 1 Use  $\uparrow$  or  $\downarrow$  to assign the component video 1 input (**DVD**, **TV**, **VCR** or **OFF**).

### Component video 2:

- Default setting: **TV**

- 2 Use  $\uparrow$  or  $\downarrow$  to assign the component video 2 input (**DVD**, **TV**, **VCR** or **OFF**).

## Surround back channel input setting

- Default setting: **SB 2ch IN**

You only have to make this setting if you are using a separate component for decoding DVDs, and the component has only one surround back channel output. If this is the case, select **SB 1ch IN**, otherwise leave it set to **SB 2ch IN**.

- Use  $\uparrow$  or  $\downarrow$  to select **SB 2ch IN** or **SB 1ch IN**.



### Coaxial digital input settings

Here you tell the receiver what components you have hooked up to the coaxial **DIGITAL IN** jacks 1 and 2 on the back of the receiver.

#### Coaxial digital 1:

- Default settings: **DVD/LD**

**1 Use ↑ or ↓ to assign the coaxial digital 1 input (DVD, TV, CD, CD-R, VCR or OFF).**

#### Coaxial digital 2:

- Default setting: **CD**

**2 Use ↑ or ↓ to assign the coaxial digital 2 input (DVD, TV, CD, CD-R, VCR or OFF).**

After you assign a component to a digital jack, whenever you select that component, (for example, a DVD player) the receiver automatically changes to the digital input setting and **DIGITAL** shows in the display.

### Optical digital input settings

Here you tell the receiver what components you have hooked up to the optical **DIGITAL IN** jack(s) on the back of the receiver.

#### Optical digital 1:

- Default settings: **TV/SAT**

**1 Use ↑ or ↓ to assign the optical digital 1 input (DVD, TV, CD, CD-R, VCR or OFF).**

#### Optical digital 2

- Default setting: **CDR/TAPE/MD**

**2 Use ↑ or ↓ to assign the optical digital 2 input (DVD, TV, CD, CD-R, VCR or OFF).**

After you assign a component to a digital jack, whenever you select that component, (for example, a DVD player) the receiver automatically changes to the digital input setting and **DIGITAL** shows in the display.

## Setting the relative volume level of each channel

- Default setting: **0db**

For best surround sound playback, you should set the relative channel levels from the main listening position. You can set separate levels for each surround mode.

- 1 Press **RCV**.
- 2 Press **STANDARD**.
- 3 Press **TEST TONE** to output the test tone.

The test tone is output in the following order (depending on the speaker setting):

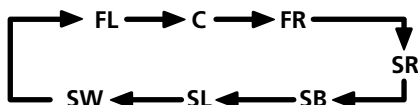

### Note

If you don't hear a test tone from one of your speakers, please refer to *Speaker setting* on page 37 to make sure you have correctly specified your speaker setup.

- 4 Press **MASTER VOLUME +/-** to adjust the volume to an appropriate level.
- 5 Use **LEVEL +/-** to adjust the speaker levels in turn.

You should hear the test tone at the same volume from each speaker when seated in the main listening position. The channel level range is  $\pm 10$  dB.

- 6 When you're done, press **TEST TONE** to turn off the test tone.



### Tip

The speaker volume can be adjusted without outputting the test tone by pressing **CH SELECT** and then using **LEVEL +/-**.



### Note

- Test tone is only output in Standard modes.
- Since the subwoofer transmits an ultra-low frequency its sound may seem quieter than it actually is.

## Listening to the radio

The following steps show you how to tune in to FM and AM radio broadcasts using the automatic (search) and manual (step) tuning functions. If you already know the frequency of the station you want, see *Tuning directly to a station* below. Once you are tuned to a station you can memorize the frequency for recall later—see *Saving station presets* on the next page for more on how to do this.

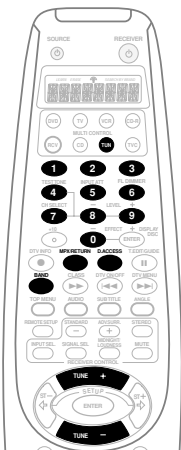

### 1 Press the TUN button on the remote control to select the tuner.

You can also use the **MULTI JOG/INPUT SELECTOR** dial on the front panel.

### 2 Use the BAND button to change the band (FM or AM), if necessary.

Each press switches the band between FM and AM.

### 3 Tune to a station.

There are three ways to do this:

#### Automatic tuning

To search for stations in the currently selected band, press and hold **TUNE +/-** for about a second. The receiver will start searching for the next station, stopping when it has found one. Repeat to search for other stations.

#### Manual tuning

To change the frequency one step at a time, press **TUNE +/-**.

#### High speed tuning

Press and hold **TUNE +/-** for high speed tuning. Release the button at the frequency you want.

## Improving FM stereo sound

If the **TUNED** or **STEREO** indicators don't light when tuning to an FM station because the signal is weak, press the **MPX(/RETURN)** button to switch the receiver into mono reception mode. This should improve the sound quality and allow you to enjoy the broadcast.

## Tuning directly to a station

Sometimes, you'll already know the frequency of the station you want to listen to. In this case, you can simply enter the frequency directly using the number buttons on the remote control.

### 1 Press the TUN button on the remote control to select the tuner.

You can also use the **MULTI JOG/INPUT SELECTOR** dial on the front panel.

### 2 Use the BAND button to change the band (FM or AM), if necessary.

Each press switches the band between FM and AM.

### 3 Press D.ACCESS (Direct Access).

### 4 Use the number buttons to enter the frequency of the radio station.

For example, to tune to **106.00** (FM), press **1, 0, 6, 0, 0**.

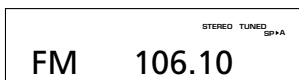

If you make a mistake halfway through, press **D.ACCESS** twice to cancel the frequency and start over.

## Saving station presets

If you often listen to a particular radio station, it's convenient to have the receiver store the frequency for easy recall whenever you want to listen to that station. This saves the effort of manually tuning in each time. This unit can memorize up to 30 stations, stored in three banks, or classes, (A, B and C) of 10 stations each. When saving an FM frequency, the **MPX** setting (see previous page) is also stored. Use the front panel controls to store station presets.

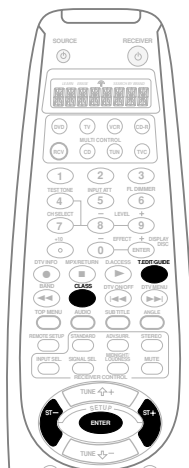
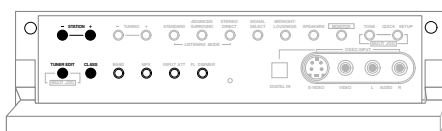
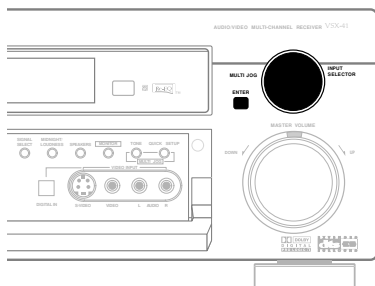

### 1 Tune to a station you want to memorize.

See *Listening to the radio* (previous page) for more on this.

### 2 Press T.EDIT (TUNER EDIT).

The display shows **ST. MEMORY**, then a blinking memory class.

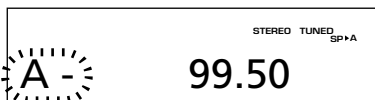

### 3 Press CLASS to select one of the three classes then press ST +/- (STATION +/-) or the ← and → keys to select the station preset you want.

You can also use the **MULTI JOG/INPUT SELECTOR** dial (front panel) to select a station preset.

### 4 Press ENTER.

After pressing **ENTER**, the preset class and number stop blinking and the receiver stores the station.

## Naming station presets

For easier identification, you can name your station presets.

### 1 Choose the station preset you want to name.

See *Listening to station presets* (this page) for how to do this.

### 2 Press T.EDIT (TUNER EDIT).

The display shows **ST. NAME**, then a blinking cursor at the first character position.

### 3 Input the name you want.

Names can be up to four characters long.

- Use the **MULTI JOG/INPUT SELECTOR** dial or **ST +/-** buttons (front panel) the **←** and **⇒** buttons (remote) to select characters.
- Press **ENTER** to confirm a character. If no character is input, a space is input.
- The name is stored when **ENTER** is pressed after choosing the fourth character.



#### Note

To erase a station name, simply repeat steps 1-3 and input four spaces instead of a name.



#### Tip

Once you have named a station preset, you can press **DISPLAY** when listening to a station to switch the display between the name and the frequency.

## Listening to station presets

If you haven't already stored some station presets, see the previous page to do so.

### 1 Press TUN (remote) or use the MULTI JOG/INPUT SELECTOR dial on the front panel to select the tuner.

### 2 Press CLASS to select the class in which the station is stored.

Press repeatedly to cycle through classes A, B and C.

### 3 Press ST +/- (STATION +/-) to select the station preset you want.



#### Note

- If the receiver is left disconnected from the AC power outlet for an extended period, the station memories will be lost and will have to be reprogrammed.

## Making an audio or a video recording

You can make an audio or a video recording from the built-in tuner, or from an audio or video source connected to the receiver (such as a CD player or TV).

Keep in mind you can't make a digital recording from an analog source or vice-versa, so make sure the components you are recording to/from are hooked up in the same way (see pages 13–19 for more on connections).

If you want to record a video source, you also need use the same type of connection for the source as for the recorder. For example, you can't record a component hooked up to S-video jacks with a recorder hooked up to the component video outputs (see page 17 for more on video connections).



### Note

The receiver's volume, balance, tone (bass, treble, loudness), and surround effects have no effect on the recorded signal.

#### 1 Select the source you want to record.

Use the **MULTI CONTROL** buttons on the remote (or **MULTI JOG/INPUT SELECTOR** dial on the front panel).

#### 2 Select the input signal (if necessary).

Press **SIGNAL SEL (SIGNAL SELECT)** to select the input signal corresponding to the source component (see page 32 for more on this).

#### 3 Prepare the source you want to record.

Tune to the radio station, load the CD, video, DVD etc.

#### 4 Prepare the recorder.

Insert a blank tape, MD, video etc. into the recording device and set the recording levels.

Refer to the instructions that came with the recorder if you are unsure how to do this. Most video recorders set the audio recording level automatically—check the component's instruction manual if you're unsure.

#### 5 Start recording, then start playback of the source component.

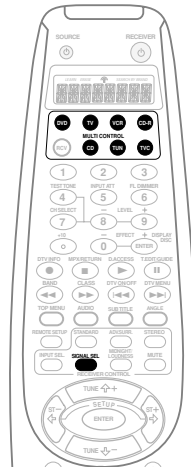

## Monitoring your recording

You can listen to (monitor) the recording as it's being made using the **MONITOR** button on the front panel (a cassette deck would have to have a record monitor function).

- Press the **MONITOR** button to switch between the recorded signal and the original source signal.

## Setting the remote to control other components

There are several ways to set your remote to control the other components in your system. The easiest way to do this is to assign the component's manufacturer preset code (listed on page 55) to one of the **MULTI CONTROL** buttons on the remote control.

The buttons can be set to control the following components:

Button	Controllable Components
<b>DVD:</b>	DVD or LD player
<b>TV:</b>	TV or Satellite tuner
<b>VCR:</b>	VCR or Digital Video Recorder
<b>CD:</b>	CD player
<b>CD-R:</b>	CD Recorder, Tape deck or MD player
<b>TVC:</b>	TV or Cable TV tuner
<b>TUN:</b>	FM/AM tuner

You can do this directly, or by searching through different preset codes until you find the right one. If you can't find a preset code that matches the component you want to control, you can still teach the remote individual commands from another remote control (page 49–50).



### Note

You can cancel or exit any of the steps by pressing and holding **MUTE** for three seconds.

## Selecting preset codes directly

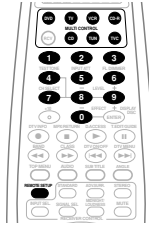

- 1 Press and hold **REMOTE SETUP** for three seconds.  
The LCD display shows **SETUP**.
- 2 Press the **MULTI CONTROL** button for the component you want to control.
- 3 Use **←** and **→** to select **DIR SET** then press **REMOTE SETUP**.  
The LCD on the remote displays the component you want to control.
- 4 Use the number buttons to enter the 4 digit preset code (see pages 55–66)

The LCD display shows the code as you enter it. If you make a mistake press the **←** button to go back one digit. The display shows **OK** once you have entered a valid code. If it's an invalid code or an error has occurred, **ERROR** shows in the display.

If you get an error message, check the preset code list and try again. If you can't find or properly enter a preset code, you can still teach the remote individual commands from another remote control (page 49).



### Note

- If you assign a preset code for the **TUNER** button, you won't be able to control the built-in tuner of this receiver using the remote. Reset the remote to the built-in tuner by entering the preset code **7008**.
- 5 Repeat steps 1 through 4 for the other components you want to control.

## Setting Up Using Full Library Search

An alternative method of setting up the remote with preset codes is to use the Library Search feature. The remote transmits batches of 10 codes; when you see the component you want to control respond (by turning on or off) you just scan through those last 10 codes until you find the correct one.



- 1 Switch on the component you want to control.

If the component is some kind of player (CD player, VCR, etc.), then start it playing.

- 2 Press and hold **REMOTE SETUP** for three seconds.

The LCD display shows **SETUP**.

- 3 Press the **MULTI CONTROL** button for the component you want to control.
- 4 Use the  $\leftarrow$  and  $\rightarrow$  buttons to select the **SEARCH**.

The LCD display shows **SEARCH**.

- 5 Press and hold **REMOTE SETUP** for three seconds.

A batch of 10 codes is transmitted and the transmit icon blinks during transmission.

If you see the component respond, by stopping (for playback components only) or switching off, go on to the step 6, otherwise press and hold the **REMOTE SETUP** button for three seconds.

Canceling this step can only be done after the 10 codes are transmitted.

- 6 Switch the component back on or restart playback.
- 7 Use  $\uparrow$  and  $\downarrow$  buttons to scan step-by-step through the last 10 codes transmitted to identify the correct code.

Stop when you see the component stop or switch off. The LCD display shows the I.D.

You can also verify you have the correct code by pressing **PLAY**, **STOP**, **VOL +/-**, etc.

- 8 Press and hold **ENTER** for three seconds to save the preset code.

The LCD display shows **OK**.

The remote control automatically returns to normal usage.

### Note

- Unless otherwise stated, you can cancel or exit any of the steps by pressing and holding **MUTE** for three seconds.
- The remote control will return to its previous mode after 30 seconds of inactivity.



## Searching for preset codes using brand names

Another way of assigning preset codes is to use the Brand Search feature.

### 1 Switch on the component you want to control.

If the component is some kind of player (CD player, VCR, etc.), then start it playing.

### 2 Press and hold **REMOTE SETUP** for three seconds to enter the setup mode.

The LCD display shows **SETUP**.

### 3 Press the **MULTI CONTROL** button for the component you want to control.

### 4 Use the $\leftarrow$ and $\rightarrow$ buttons to select **BRAND** then press **REMOTE SETUP**.

The brand names are displayed in alphabetical order. The display starts by showing the letter **A**.

### 5 Use $\uparrow$ and $\downarrow$ to select the first letter of the brand of your component then press **ENTER**.

The LCD will show the brands that start from the letter you have selected.

If you make a mistake here, press  $\leftarrow$  to go back to the previous step.

### 6 Use $\uparrow$ and $\downarrow$ to select the brand of your component then press **ENTER**.

The LCD shows the component type and codes relating to the brand.

### 7 Use $\uparrow$ and $\downarrow$ to select your component type (if you see the component respond) then press and hold **ENTER** for three seconds to save the preset code.

The LCD display shows **OK**.

## Programming signals from other remote controls

If the preset code for your component is not available, or the available preset codes do not operate correctly, you can program signals from the remote control of another component. This can also be used to program additional operations (buttons not covered in the presets) after assigning a preset code.

### 1 Press **REMOTE SETUP** and hold for three seconds.

The LCD display shows **SETUP**.

### 2 Press the **MULTI CONTROL** button for the component you want to control.

### 3 Prepare the remote to learn the remote control signal from the component.

Use  $\leftarrow$  and  $\rightarrow$  to select **LEARN** and then press **REMOTE SETUP**.

The LCD display shows **PRES KEY**. The learn icon indicates the remote is ready to accept a signal.



#### Note

To exit or cancel press and hold the **SETUP** key for three seconds.

### 4 Point the two remote controls towards each other about 1-2 inches apart then press the button that will be doing the learning on this receiver's remote control (for example $\blacktriangleright$ , $\blacksquare$ , etc.).

The LCD display flashes **PRES KEY**.

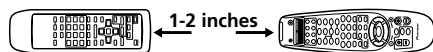

### 5 Press the corresponding button on the other remote control that is sending (teaching) the signal to this receiver's remote control (for example $\blacktriangleright$ , $\blacksquare$ , etc.).

The LCD display will show **OK** if the operation has been learned.

If for some reasons the operation hasn't been learned the LCD will display **ERROR** for three seconds and then display **PRES KEY** again. If this happens, keep pressing the (teaching) button as you vary the distance between the two remotes, until the LCD display shows **OK**.

To program additional operations for the current component repeat steps 4 and 5.

To program operations for another component exit and repeat steps 1 through 5.

- 6 Press and hold the **REMOTE SETUP** button for three seconds to store the operation(s).



#### Note

- Some commands from other remote controls cannot be learned, but in most cases the remotes just need to be moved closer together or farther apart.

- Certain buttons represent operations that cannot be learned from other remote controls.

These include: **MULTI CONTROL**, **RECEIVER** , **REMOTE SETUP**, **RECEIVER CONTROL** and **MASTER VOLUME**.

- **TV CONTROL** buttons (**TV**, **TV VOL +/-**, and **TV INPUT**) can only be learned after selecting **TV** or **TVC**.

## Erasing one of the remote control button settings



This erases one of the buttons you have programmed and restores the button to the factory default.

- 1 Press **REMOTE SETUP** and hold for three seconds.

The LCD display shows **SETUP**.

- 2 Press the **MULTI CONTROL** button relating to the button setting to be erased.

- 3 Prepare the remote to erase the button setting.

Use  and  to select **ERASE** and then press **REMOTE SETUP**.

The LCD display flashes **PRES KEY**.

- 4 Press and hold the button to be erased for three seconds.

The LCD display shows **OK** to confirm the button has been erased or **NO CODE** if an error has occurred.

- 5 Repeat step 4 to erase other buttons.

- 6 Press and hold the **REMOTE SETUP** button for two seconds to exit.

## Clearing all the remote control settings

You can clear all presets and restore the factory default settings.

- 1 Press **REMOTE SETUP** and hold for three seconds.

The LCD display shows **SETUP**.

- 2 Press any **MULTI CONTROL** button.

- 3 Use  and  to select **RESET** then press **REMOTE SETUP**.

The LCD display shows **OK**.

## Direct function

- Default setting: **ON**

You can use the direct function feature to control one component using the remote control while at the same time, using your receiver to playback a different component. This could let you, for example, use the remote control to set up and listen to a CD on the receiver and then use the remote control to rewind a tape in your VCR while you continue to listen to your CD player.

When direct function is on, any component you select (using the **MULTI CONTROL** buttons) will be selected by both the receiver and the remote control. When you turn direct function off, you can operate the remote control without affecting the receiver.

- 1 Press **REMOTE SETUP** and hold for **three seconds**.

The LCD display shows **SETUP**.

- 2 Press the **MULTI CONTROL** button for the component you want to control.

- 3 Use  $\leftarrow$  and  $\rightarrow$  to select **DIR SET** then press **REMOTE SETUP**.

The LCD on the remote displays the component you want to control.

- 4 Use the number buttons to enter either **9990 (direct on)** or **9995 (direct off)**.

The LCD will display **OK** to show the four digit code has been accepted.



### Note

You can't use direct function for **TV INPUT**.

## Confirming preset codes

Use this feature to check which preset code is assigned to a **MULTI CONTROL** button.

- 1 Press **REMOTE SETUP** and hold for **three seconds**.

The LCD display shows **SETUP**.











- 2 Press the **MULTI CONTROL** button of the component for which you want to check the preset code.

- 3 Use  $\leftarrow$  and  $\rightarrow$  to select **READ ID** and then press **REMOTE SETUP**.

The preset code appears in the display for two seconds.

## Controls for TVs

This remote control can control components after entering the proper codes or teaching the receiver the commands (see pages 55–66). Use the **MULTI CONTROL** buttons to select the component.

Button (s)	Function	Components
TV 	Switches the DTV on or off.	DTV
	Switches the TV or CATV between standby and on.	Cable TV/Satellite TV/TV
<b>TV INPUT</b>	Switches the TV input. (Not possible with all models.)	TV
<b>CHANNEL</b> +/-	Selects channels.	Cable TV/Satellite TV/TV/ DTV
<b>TV VOL</b> +/-	Adjust the TV volume.	Cable TV/Satellite TV/TV/ DTV
<b>SOURCE</b> 	Press to switch the component assigned to the <b>TVC</b> button on or off.	DTV
	Switches DTV on or off.	DTV
	Press to display the DTV menu.	DTV
	Use as the <b>GUIDE</b> button for navigating	DTV
	Press to get information on DTV programs.	DTV
<b>TOP MENU</b>	Use to choose the BLUE commands on a DTV menu.	DTV
<b>AUDIO</b>	Use to choose the GREEN commands on a DTV menu.	DTV
<b>SUB TITLE</b>	Use to choose the RED commands on a DTV menu.	DTV
<b>ANGLE</b>	Use to choose the YELLOW commands on a DTV menu.	DTV
	Selects between screen formats for widescreen TVs.	TV
	Use to clear a TV channel selected using the number buttons.	Cable TV/TV
	Use to switch DTV audio tracks	DTV
	Use to select closed captioning with DTV.	DTV
<b>Number Buttons</b>	Use to select a specific TV channel.	Cable TV/Satellite TV/TV/ DTV
<b>+10 button</b>	Use to add a decimal point when selecting a specific TV channel.	DTV
<b>ENTER/ DISPLAY/ DISC</b>	Use to enter a channel.	Cable TV/Satellite TV/TV

Button (s)	Function	Components
<b>MENU</b>	Select different menus from the DTV functions.	DTV
	Select the menu screen.	Cable TV/Satellite TV/TV
↔↕↖↗ & <b>ENTER</b>	Select or adjust and navigate items on the menu screen. <b>ENTER</b> brings up the DTV menus.	DTV
	Press to select or adjust and navigate items on the menu screen.	Cable TV/Satellite TV/TV/ DTV
<b>EFFECT</b> +/-	For TV and cable TV use this button to immediately enter a new channel (CHANNEL ENTER function). For satellite TV use this button to exit the menu screen.	Cable TV/Satellite TV/TV/ DTV

**Note**

The four TV CONTROL buttons on the remote control are dedicated to control the TV assigned to the TVC button. Thus if you only have one TV to hook up to this system assign it to the TVC MULTI CONTROL button. If you have two TVs, assign the main TV to the TVC button.

## Controls for other components

This remote control can control these components after entering the proper codes or teaching the receiver the commands (see pages 55–66). Use the **MULTI CONTROL** buttons to select the component.

Button (s)	Function	Components
<b>SOURCE</b>	Press to switch the component between standby and on.	CD/MD/CD-R/VCR/DVD/LD/ DVR player/Cassette deck
◀◀	Press to return to the start of the current track. Repeated presses skips to the start of previous tracks.	CD/MD/CD-R/DVD/LD player
	Go back channels (channel -).	VCR/DVR
	Play the reverse side of the tape on a reversible deck.	Cassette deck
▶▶	Press to advance to the start of the next track. Repeated presses skips to the start of following tracks.	CD/MD/CD-R/LD player
	Go forward channels (channel +).	VCR
	Play the forward side of the tape on a reversible deck.	Cassette deck
<b>II</b>	Pause playback or recording.	CD/MD/CD-R/VCR/DVD/LD/ DVR player/Cassette deck
▶	Start playback.	CD/MD/CD-R/VCR/DVD/LD/ DVR player/Cassette deck

Button (s)	Function	Components
▶▶	Hold down for fast forward playback.	CD/MD/CD-R/VCR/DVD/LD/ DVR player/Cassette deck
◀◀	Hold down for fast reverse playback.	CD/MD/CD-R/VCR/DVD/LD/ DVR player/Cassette deck
■	Stops playback (on some models, pressing this when the disc is already stopped will cause the disc tray to open).	CD/MD/CD-R/VCR/DVD/LD/ DVR player/Cassette deck
●	Starts recording. To prevent accidental recording, this button must be pressed twice to take effect (the second press must be within 10 seconds of the first).	VCR/DVR player
Number buttons	Directly access tracks on a program source.	CD/MD/CD-R/VCR/LD player
	Use the number buttons to navigate the on-screen display.	DVD/DVR player
+10 button	Selects tracks higher than 10. (For example, press +10 then 3 to select track 13.)	CD/MD/CD-R/VCR/LD player
ENTER	Chooses the disc.	Multiple CD player
(DISPLAY/ DISC)	Ejects the disc.	MD player
DISC)	Use as the ENTER button.	VCR
	Displays the setup screen for DVD/DVR players.	DVD/DVR player
	Changes sides of the LD.	LD player
	Use as the SET UP button.	DVD/DVR player
MENU	Displays menus concerning the current DVD or DVR you are using.	DVD/DVR player
↑	Pauses the tape.	CD-R/Cassette deck
↓	Stops the tape.	CD-R/Cassette deck
ENTER	Starts playback.	CD-R/Cassette deck
↔/⇒	Fast rewinds/fast forwards the tape.	CD-R/Cassette deck
↔⇒↑↓ & ENTER	Navigates DVD menu/options.	DVD/DVR Player
CHANNEL	Selects channels.	VCR/DVD/DVR Player
+/-	Selects tracks.	CD/MD/CD-R/Cassette deck
TOP MENU	Displays the disc 'top' menu of a DVD.	DVD/DVR Player
AUDIO	Changes the audio language or channel.	DVD/DVR Player
SUBTITLE	Displays/changes the subtitles on multilingual DVDs.	DVD/DVR Player
ANGLE	Switches camera angles on discs with multi-angle scenes.	DVD/DVR Player

## Preset Code List

You can only set these codes for the buttons that assigned to the respective components. So, for example, the TV codes can only be set to the TV or TVC button.

### TV



Manufacturer	Code	
PHILIPS	1008, 1017, 1020, 1025, 1104, 1115	
SONY	1001, 1007, 1016	
PANASONIC	1023, 1054, 1055, 1075, 1076, 1082, 1087, 1121, 1124	
TOSHIBA	1015, 1016, 1027, 1031, 1050, 1051, 1085	
TELEFUNKEN	1005, 1026, 1034, 1038, 1042, 1046, 1075, 1097	
SHARP	1016, 1019, 1041, 1056, 1124	
SAMSUNG	1006, 1011, 1013, 1017, 1026, 1027, 1039, 1062, 1079, 1089, 1092, 1102	
FERGUSON	1005, 1017, 1033, 1046, 1065, 1084, 1091	
MITSUBISHI	1011, 1016, 1041, 1045, 1049, 1062, 1114	
GOLDSTAR	1002, 1011, 1013, 1017, 1019, 1026, 1046, 1062, 1079, 1092	
BLAUPUNKT	1066, 1068, 1071, 1075, 1115	
RADIOLA	1008, 1017	
JVC	1016, 1024, 1030, 1053, 1065, 1067, 1103, 1122	
DAEWOO	1006, 1011, 1017, 1019, 1028, 1040, 1050, 1104, 1110, 1118, 1119	
ORION	1017, 1063, 1083, 1095, 1098, 1099, 1112	
SIEMENS	1017, 1052, 1066, 1068, 1071, 1075, 1115	
ADMIRAL	1041, 1055, 1075, 1112	
ADYSON	1014, 1079	
AIKO	1040	
AKAI	1013, 1074	
AKURA	1080, 1089	
ACURA	1006	
ALARON	1063, 1078	
ALBA	1006, 1016, 1017, 1080, 1103	
ALLORGAN	1095	
ANAM	1004, 1006, 1029, 1054, 1064, 1087, 1108	
ANAM NATIONAL	1054, 1087, 1108	
AMBASSADOR	1061	
AMERICA ACTION	1064	
AMPLIVISION	1079	
AMPRO	1126	
AMSTRAD	1006, 1017, 1103, 1105	
ANITECH	1006, 1029, 1036	
AOC	1011, 1013	
ARCAM	1078, 1079	
ASBERG	1036	
ASUKA	1080	
ATLANTIC	1073	
AUDIOSONIC	1017, 1046	
AUDIOVOX	1040, 1064, 1110, 1118	
AUTOVOX	1036, 1073	
BANG & OLUFSEN	1116	
BASIC LINE	1006, 1080	
BAYSONIC	1064	
BAUR	1007, 1017, 1114, 1115	
BEKO	1102	
BELCOR	1011	
BELL & HOWELL	1009, 1050	
BEON	1017	
BINATONE	1079	
BLUE SKY	1080	
BLUE STAR	1090	
BONDSTEC	1086	
BOOTS	1079	
BPL	1090	
BSR	1095	
BRADFORD	1064	
BRANDT	1046, 1069, 1070, 1072	
BRITANNIA	1078	
BROCKWOOD	1011	
BROKSONIC	1083, 1112	
BTC	1080	
BUSH	1006, 1016, 1017, 1080, 1090, 1095, 1103, 1104	
CANDLE	1013, 1026	
CARNIVALE	1013	
CARREFOUR	1016	
CARVER	1025, 1058	
CASCADE	1006	
CATHAY	1017	
CENTURY	1075	
CENTURION	1017	
CELEBRITY	1001	
CCE	1017	
CGE	1034, 1036, 1038, 1086, 1097	
CIMLINE	1006	

CINERAL	1040, 1110	FRONTECH	1055, 1086, 1089, 1109
CITIZEN	1013, 1019, 1026, 1027, 1040	FUJITSU	1032, 1063, 1073
CLARIVOX	1017	FUNAI	1059, 1063, 1064, 1089, 1095, 1096
CLATRONIC	1036, 1086, 1102	FUTURETECH	1064
CME	1007, 1015, 1114	GE	1012, 1022, 1023, 1041, 1062, 1090, 1110, 1129, 1131
CONCERTO	1026	GEC	1017, 1020, 1032, 1072, 1079
CONDOR	1098, 1102	GELOSO	1006, 1075
CONTEC	1006, 1016, 1064, 1078	GENEXXA	1055, 1080
CONTINENTAL EDISON	1069, 1070, 1072	GIBRALTER	1010, 1011, 1013
CRAIG	1054	GOODMANS	1016, 1017, 1032, 1079, 1103, 1104
CROSLEY	1025, 1034, 1036, 1038, 1075	GORENJE	1102
CROWN	1006, 1017, 1019, 1036, 1064, 1102, 1106	GPM	1080
CRYSTAL	1109	GRAETZ	1055
CS ELECTRONICS	1078	GRANADA	1017, 1032, 1048, 1074, 1079, 1100
CTC	1086	GRADIENTE	1024, 1026, 1058
CURTIS MATHES	1009, 1013, 1019, 1022, 1023, 1025, 1026, 1027, 1041, 1047, 1050, 1057, 1110, 1113, 1129, 1131	GRANDIN	1090
CYBERTRON	1080	GRUNDIG	1031, 1066, 1068, 1072, 1115
CXC	1064	GRUNPY	1063, 1064
DAINICHI	1077, 1080	HALLMARK	1062
DANSAI	1017	HANSEATIC	1017, 1098
DAYTRON	1006, 1011	HARLEY DAVIDSON	1063
DECCA	1017, 1032	HARVARD	1029, 1064
DE GRAAF	1074	HARMAN/KARDON	1025
DENON	1047	HCM	1006, 1090, 1105
DIXI	1006, 1017	HINARI	1006, 1016, 1017, 1080
DUAL TEC	1079	HISAWA	1090, 1111
DUMONT	1010, 1011, 1031	HITACHI	1014, 1016, 1018, 1020, 1021, 1026, 1044, 1046, 1047, 1055, 1069, 1070, 1079, 1081, 1097
DWIN	1125, 1127	HUANYU	1078, 1104
ECE	1017	HYPSON	1017, 1089, 1090
ELBE	1088	ICE	1079, 1089, 1103
ELECTROBAND	1001	ICES	1080
ELIN	1017	IMPERIAL	1034, 1036, 1038, 1086, 1102, 1106
ELITE	1080, 1098	INDIANA	1017
ELTA	1006	INFINITY	1025
EMERSON	1011, 1018, 1019, 1050, 1061, 1062, 1063, 1064, 1075, 1083, 1090, 1112, 1118, 1119	INGELEN	1055
ENVISION	1013	INNO HIT	1032
ERRES	1008, 1017	INNOVA	1017
ETRON	1006, 1120	INTEQ	1010
EXPERT	1073	INTERBUY	1029
FIDELITY	1078	INTERFUNK	1017, 1055, 1086, 1114
FINLANDIA	1074	INTERVISION	1017, 1029, 1043, 1079, 1089
FINLUX	1017, 1031, 1032, 1044	ISUKAI	1080
FISHER	1050, 1074, 1079, 1096, 1102	ITS	1103
FLINT	1111	ITT	1055
FORMENTI	1017, 1075, 1098		
FORTRESS	1041		



JBL	1025	NAD	1051, 1057, 1062
JCB	1001	NEC	1011, 1013, 1016, 1026, 1058
KAISUI	1006, 1078, 1079, 1080, 1090,	NECKERMANN	1017, 1066, 1075, 1115
KAMP	1078	NEI	1017, 1109
KAPSCH	1055, 1073	NETSAT	1017
KAWASHO	1078	NICAMAGIC	1078
KEC	1064	NIKKAI	1014, 1015, 1017, 1032, 1078, 1080, 1089
KENDO	1017	NIKKO	1013, 1040, 1062
KNEISSEL	1088	NOBLIKO	1036, 1043
KENWOOD	1011, 1013	NORDMENDE	1046, 1069, 1070, 1075, 1091
KINGSLEY	1078	NTC	1040
KONIG	1114	OCEANIC	1055, 1077
KORPEL	1017	ONWA	1064
KOYODA	1006	OPTIMUS	1050, 1057, 1087
KTV	1013, 1019, 1064	OPTONICA	1041, 1056
LEYCO	1017, 1032, 1089, 1095	OSAKI	1014, 1032, 1079, 1080, 1089, 1105
LG	1026	OSO	1080
LIESENK&TTER	1017	OSUME	1014, 1032, 1052
LLOYTRON	1014	OTTO	1007, 1114
LOEWE	1035, 1114	OTTO VERSAND	1007, 1016, 1017, 1066, 1075, 1079, 1098, 1115
LOGIK	1009	PALLADIUM	1102, 1106
LUMA	1073	PANAMA	1079, 1089
LUXMAN	1026	PATHE MARCONI	1069, 1070, 1072
LXI	1022, 1025, 1050, 1051, 1062	PATHE CINEMA	1075, 1078, 1084, 1098
M ELECTRONIC	1006, 1017, 1029, 1044, 1046, 1055, 1079, 1091, 1104	PAUSA	1006
MAGNAVOX	1013, 1016, 1025, 1063	PENNEY	1003, 1011, 1012, 1013, 1019, 1022, 1023, 1026, 1027, 1051, 1062, 1131
MAGNADYNE	1043, 1086	PERDIO	1098
MAGNAFON	1036, 1043, 1075	PHAPSODY	1078
MAJESTIC	1009	PHASE	1014
MANESTH	1079, 1089, 1098	PHILCO	1011, 1013, 1025, 1034, 1036, 1038, 1047, 1075, 1086, 1112
MARANTZ	1013, 1017, 1025	PHONOLA	1008, 1017
MARK	1017	PILOT	1011, 1013, 1019
MATSUI	1006, 1015, 1016, 1017, 1032, 1074, 1079, 1095, 1103	PORTLAND	1011, 1019, 1040
MATSUSHITA	1087	PRISM	1023
MCMICHAEL	1020	PROFEX	1006, 1037
MEDIATOR	1008, 1017	PROLINE	1099
MEGATRON	1047, 1062	PROSOCAN	1022
MEMOREX	1006, 1009, 1026, 1049, 1050, 1062, 1087, 1112	PROTECH	1006, 1017, 1043, 1079, 1086, 1089, 1106, 1109
METZ	1075	PROTON	1062, 1113
MGA	1011, 1013, 1049, 1062	PULSAR	1010, 1011
MIDLAND	1010, 1019, 1022, 1023	PYE	1008
MINERVA	1031, 1115	QUASAR	1023, 1056, 1087
MINOKA	1105	QUELLE	1007, 1017, 1031, 1034, 1038, 1071, 1075, 1097, 1114, 1115
MINUTZ	1012	QUESTA	1016
MIVAR	1078, 1092, 1093, 1094	R-LINE	1017
MOTION	1036		
MOTOROLA	1041		
MTC	1011, 1013, 1026, 1027, 1078, 1114		
MULTITECH	1006, 1036, 1043, 1064, 1078		

RANK ARENA	1016	SOUNDWAVE	1017, 1106
RBM	1031	SQUAREVIEW	1059
RCA	1011, 1018, 1022, 1023, 1039, 1041, 1128, 1129, 1130, 1131, 1132	STANDARD	1006, 1079, 1080
REALISTIC	1011, 1013, 1019, 1026, 1050, 1056, 1062, 1064	STARLITE	1064
REX	1055, 1073, 1088, 1089	STERN	1055, 1073, 1088
REVOX	1017	SUNKAI	1095, 1099
ROADSTAR	1006, 1080, 1089, 1106	SUPERTECH	1078
RUNCO	1010, 1013, 1117	SUPREME	1001
SABA	1035, 1046, 1055, 1069, 1070, 1072, 1075, 1091	SUSUMU	1080
SACCS	1084	SYLVANIA	1013, 1025
SAISHO	1006, 1089, 1109	SYMPHONIC	1059
SALORA	1055	SYSLINE	1017
SAMBERS	1036, 1043, 1075	TANDY	1032, 1041, 1055, 1079, 1080
SAMPO	1013, 1019	TASHIKO	1016, 1020, 1079
SAMSUX	1019	TEC	1079, 1086
SANDRA	1078	TECHNEMA	1098
SANSEI	1110	TECHNICS	1023, 1087, 1121
SANSUI	1112	TECHNOL ACE	1063
SANYO	1016, 1032, 1048, 1050, 1052, 1074, 1075, 1100	TECHWOOD	1023, 1026
SBR	1008, 1017, 1020	TEKNIKA	1009, 1011, 1019, 1025, 1026, 1027, 1040, 1049, 1063, 1064
SCHNEIDER	1017, 1080, 1086, 1096, 1103	TELEAVIA	1072
SCIMITSU	1011	TELEMEISTER	1098
SCOTCH	1062	TELETECH	1006
SCOTT	1011, 1062, 1063, 1064, 1083	TELETON	1016, 1073, 1079
SEARS	1022, 1025, 1026, 1050, 1051, 1059, 1062, 1063	TENSAI	1080, 1095, 1098
SEG	1016, 1036, 1079, 1089	TEXET	1078, 1080
SEI	1043, 1075, 1095	THOMSON	1046, 1069, 1070, 1072, 1091
SEI-SINUDYNE	1007	THORN	1015, 1017, 1032, 1034, 1038, 1065, 1067, 1114
SELECO	1055, 1073, 1088	TMK	1026, 1061, 1062
SEMIVOX	1064	TOMASHI	1090
SEMP	1051	TOTEVISION	1019
SENTRA	1015	TRIUMPH	1085
SHOGUN	1011	TUTUNG	1017, 1032, 1079
SHORAI	1095	UHER	1073, 1096, 1098
SSS	1011, 1064	ULTRA	1067
SIAREM	1043, 1075	ULTRAVOX	1043
SINDYNE	1043, 1075, 1095	UNIVERSUM	1017, 1044, 1089, 1102
SIGNATURE	1009	VECTOR RESEARCH	1013
SILVER	1016	VESTEL	1017
SKY	1017	VICTOR	1016, 1024, 1053, 1087
SKY-WORTH	1017	VIDEOSAT	1086
SOLAVOX	1014, 1055	VIDEOTECHNIC	1079
SONITRON	1074	VIDIKRON	1025
SONOKO	1006, 1017	VIDTECH	1011, 1016, 1062
SONOLOR	1055, 1074, 1077	VISION	1098
SONTEC	1017	VOXSON	1055
SOUNDESIGN	1062, 1063, 1064	WALTHAM	1079
		WATSON	1017, 1098
		WATT RADIO	1043
		WARDS	1009, 1011, 1012, 1013, 1025, 1026, 1056, 1062, 1063
		WEGA	1016

WHITE WESTINGHOUSE	1017, 1078, 1098, 1112, 1118, 1119
YAMAHA	1011, 1013
YOKO	1017, 1079, 1101, 1109
ZANUSSI	1073
ZENITH	1009, 1010, 1040, 1112
PIONEER	1018, 1046, 1055, 1057, 1060, 1091, 1107, 1123, 1124

## MD PLAYER



Manufacturer	Code
SONY	5401
KENWOOD	5402, 5407
SHARP	5403
ONKYO	5404
ORION	5406
DENON	5405
PIONEER	5408

## LD PLAYER



Manufacturer	Code
AKAI	5222
BBK	5224
CYRUS	5207
DENON	5202
DISCO VISION	5201
FUNAI	5217
HITACHI	5201
HONG DENG	5213
IDALL	5219
KEBAO	5215
MARANTZ	5203, 5205
mitsubishi	5202
NAD	5202
PANASONIC	5210
PHILIPS	5203, 5207, 5209
RADIOLA	5207
ROWA	5212
SALORA	5203
SEGA	5201
SHARP	5221
SHINCO	5211
SMC	5220
SONY	5204, 5206, 5216, 5218
SUPER	5215
TELEFUNKEN	5202
TOSHIBA	5223
PIONEER	5201, 5202, 5208, 5214

## CD PLAYER



Manufacturer	Code
AIWA	5016, 5021
AKAI	5014, 5020, 5032
ANAM	5041
ARCAM	5021
AUDIOLAB	5021
AUDIOMECA	5021
AUDIO TON	5021
BESTAR	5022
BURMESTER	5045
CALIFORNIA AUDIO LABS	5004
CARVER	5021, 5025, 5046
CONDOR	5018, 5022
CURTIS MATHES	5004
CYRUS	5021
DENON	5002, 5006, 5040, 5060
DKK	5001
DUAL	5031
DYNAMIC BASS	5025
EMERSON	5038
EROICA	5053, 5054
FANTASIA	5051
FISHER	5024, 5025
GARRARD	5044, 5045
GENEXXA	5005, 5038
GOLDSTAR	5043, 5051
GRUNDIG	5021
HARMAN/KARDON	5021, 5023
HITACHI	5005
INKEL	5015, 5026, 5046
JVC	5011
KENWOOD	5003, 5008, 5029, 5056, 5057, 5062
KRELL	5021
LINN	5021
LUXMAN	5036
LXI	5038
MAGNAVOX	5021, 5038
MARANTZ	5004, 5009, 5017, 5021, 5026
MATSUI	5021
MCS	5004
MEMOREX	5022
MERIDIAN	5021
MICROMEGA	5021
MISSION	5021
MITSUBISHI	5014, 5020
MTC	5045
NAD	5001
NAIM	5021
NIKKO	5024, 5041, 5051
NSM	5021

ONKYO	5012, 5013, 5042, 5059	DYNAMIC BASS	6028
OPTIMUS	5001, 5005, 5008, 5019, 5025, 5038, 5045, 5046, 5048	EROICA	6041
ORION	5061	FISHER	6028
PANASONIC	5004, 5037	GARRARD	6036
PARASOUND	5045	GOLDSTAR	6036
PHILIPS	5021, 5055	GRUNDIG	6002
PMG	5022	HARMON/KARDON	6002, 6014
POPPY	5022	INKEL	6003
PROTON	5021	JVC	6027, 6030, 6031
QED	5021	KENWOOD	6003, 6004, 6019, 6024, 6025
QUAD	5021	KYOCERA	6013
QUASAR	5004,	LOTTE	6034
RCA	5010, 5025, 5038	LUXMAN	6029
REALISTIC	5025, 5026, 5045	MAGNAVOX	6002
REVOX	5021	MARANTZ	6002
ROTEL	5021, 5045	MEMOREX	6008, 6009
SAE	5021	MITSUBISHI	6016
SANSUI	5021, 5033, 5038	NAKAMICHI	6020
SANYO	5025, 5039	NIKKO	6035
SCHNEIDER	5018	OLYMPUS	6029
SCOTT	5038	ONKYO	6010, 6011, 6032
SEARS	5038	OPTIMUS	6001, 6021
SHARP	5008, 5026, 5058	PANASONIC	6023
SHERWOOD	5015, 5026, 5031	PHILIPS	6002
SONY	5001, 5027, 5050	RCA	6028
SOUDSIGN	5019	RENAISSANCE	6040
TASCAM	5045	REVOX	6002
TEAC	5024, 5026, 5044, 5045	SAMSUNG	6038
TECHNICS	5004, 5034, 5037	SANSUI	6002
THORENS	5021	SANYO	6028
TOSHIBA	5049	SHARP	6019
UNIVERSUM	5021	SONIC	6036
YAMAHA	5007, 5028	SONY	6012, 6026, 6033
YORX	5047	TEAC	6038
VICTOR	5011	TECHNICS	6023
WARDS	5010, 5021	THORENS	6002
PIONEER	5005, 5030, 5035, 5038, 5048, 5052, 5063	VICTOR	6027, 6030
		WARDS	6001
		YAMAHA	6006, 6007, 6019
		PIONEER	6001, 6008, 6009
			6021,

## TAPE DECK



Manufacturer	Code
ADC	6013
AIWA	6002, 6022, 6017, 6018
AKAI	6015, 6016
ANAM	6035
ARCAM	6005
CARVER	6002, 6028
DENON	6005, 6039
DUAL	6037

## DVD PLAYER



Manufacturer	Code
TOSHIBA	5302
SONY	5306
PANASONIC	5301, 5322
KENWOOD	5307
JVC	5311, 5318
SAMSUNG	5313
AKAI	5316
HARMAN/KARDON	5314

MAGNAVOX	5302
MITSUBISHI	5303
ONKYO	5302, 5317, 5319
PROSCAN	5304
RCA	5304
SHARP	5320
THETA DIGITAL	5312
TECHNICS	5301
THOMSON	5310
YAMAHA	5301, 5309
PHILIPS	5302, 5308
ZENITH	5302, 5315
PIONEER	5305, 5312, 5321 5322

## AMPLIFIER



Manufacturer	Code
AUDIOLAB	8005
DENON	8002
GRUNDIG	8005
MARANTZ	8005
MICROMEGA	8005
PHILIPS	8005
PIONEER	8004
REVOX	8005
TANDBERG	8003
THORENS	8005
YAMAHA	8001, 8006

## MISC AUDIO



Manufacturer	Code
JERROLD	8201, 8203
STARCOM	8201
SCIENTIFIC ATLANTA	8202

## RECEIVERS



Manufacturer	Code
ADC	7042
AIWA	7012, 7023, 7031, 7055, 7064
AKAI	7011, 7027
ANAM	7010, 7046
ARCAM	7018, 7048
AUDIOLAB	7059
CAPETRONIC	7042
CARVER	7055, 7059
CURTIS	7008
DAEWOO	7032
DENON	7001, 7056, 7058
DUAL	7040

EROICA	7005
FANTASIA	7037
FERGUSON	7042
FINE ARTS	7059
FISHER	7028
GARRARD	7032, 7034, 7035
GOLDSTAR	7010
GOODMANS	7027
GP AUDIO	7033
GRUNDIG	7018, 7059
HARMAN/KARDON	7009, 7051
INKEL	7038, 7040
JBL	7009
JVC	7007, 7036, 7042
KENWOOD	7003, 7017, 7025, 7026, 7044, 7053, 7063, 7066

LOTTE	7037, 7039
LUXMAN	7021
MAGNAVOX	7030, 7042, 7055, 7059
MARANTZ	7004, 7018, 7055, 7059
MCINTOSH	7020
MCS	7004
MCSILVER	7037
MICROMEGA	7018, 7059
NIKKO	7032, 7037, 7046
OPTIMUS	7017, 7034, 7042, 7049, 7052
ONKYO	7013, 7029
PALLADIUM	7050
PANASONIC	7004, 7024, 7041
PHILIPS	7018, 7030, 7045, 7048, 7051, 7055, 7059

PHONOTREND	7038
QUASAR	7004
RCA	7006, 7042
RENAISSANCE	7043
REVOX	7018
ROADSTAR	7027
SABA	7042
SAISHO	7027
SAMSUNG	7010
SANSUI	7027, 7055
SANYO	7028
SCHNEIDER	7042
SHARP	7017
SHERWOOD	7038
SOUNDESIGN	7049
SONY	7015, 7054, 7057, 7060
TAE KWANG	7034
TEAC	7010, 7035
TECHNICS	7004, 7062, 7065
TELEFUNKEN	7019, 7024, 7041, 7061, 7062, 7065
THORENS	7018, 7059

UHER 7027, 7042, 7050  
 VICTOR 7007  
 WARDS 7002, 7006, 7008  
 YAMAHA 7016, 7017  
 PIONEER 7002, 7008, 7014, 7022, 7042, 7047, 7050, 7052

**VCR****Manufacturer****Code**

PHILIPS 2015, 2035, 2074, 2075  
 PANASONIC 2015, 2042, 2053, 2054, 2055, 2087  
 THOMSON 2021, 2064, 2074  
 SONY 2001, 2009, 2012, 2013, 2014, 2015  
 JVC 2008, 2021, 2033, 2049, 2050, 2074, 2080  
 GRUNDIG 2003, 2005, 2007, 2010, 2034, 2035, 2048, 2050, 2054, 2069, 2071, 2075  
 AKAI 2021, 2029, 2038, 2060, 2063  
 HITACHI 2001, 2004, 2021, 2022, 2043, 2056, 2057  
 TOSHIBA 2021, 2023, 2024, 2035, 2074  
 MITSUBISHI 2023, 2027, 2033, 2035, 2045  
 SHARP 2027, 2073  
 ORION 2002, 2004, 2016, 2036, 2046, 2052, 2070, 2072, 2078  
 SANYO 2025, 2026, 2037, 2057  
 FERGUSON 2021, 2039, 2064, 2065  
 BLAUPUNKT 2003, 2005, 2010, 2014, 2041, 2042, 2048, 2054, 2055, 2075  
 NOKIA 2025, 2037, 2038, 2057  
 ADMIRAL 2027, 2052  
 ADVENTURA 2001  
 AIKO 2059  
 AIWA 2001, 2017, 2062, 2070, 2072  
 AKIBA 2034  
 ALBA 2011, 2034, 2052, 2059, 2063, 2072  
 AMBASSADOR 2011  
 AMERICA ACTION 2059  
 AMERICAN HIGH 2015  
 AMSTRAD 2001, 2059, 2067, 2068  
 ANAM 2017, 2042, 2054, 2057, 2059, 2082, 2084  
 ANAM NATIONAL 2042, 2054, 2087  
 ANITECH 2034  
 ASA 2017, 2035  
 ASHA 2057  
 ASUKA 2017  
 AUDIOVOX 2017

BAIRD 2001, 2021, 2037, 2039  
 BASIC LINE 2011, 2034, 2059  
 BEAUMARK 2057  
 BELL & HOWELL 2037  
 BRANDT 2047, 2064, 2065  
 BRANDT ELECTRONIC 2021  
 BROKSONIC 2002, 2040, 2046, 2052, 2078  
 BUSH 2034, 2052, 2059, 2072  
 CALIX 2017  
 CANON 2015  
 CAPEHART 2011  
 CARVER 2035  
 CATRON 2011  
 CCE 2034, 2059  
 CGE 2001  
 CIMLINE 2034  
 CINERAL 2059  
 CITIZEN 2017, 2059  
 CLATRONIC 2011  
 COLT 2034  
 COMBITECH 2072  
 CONDOR 2011  
 CRAIG 2017, 2026, 2034, 2057, 2058  
 CROWN 2011, 2034, 2059  
 CURTIS MATHES 2015, 2021, 2032, 2042  
 CYBERNEX 2057  
 CYRUS 2035  
 DAEWOO 2011, 2024, 2025, 2059, 2083  
 DANSAI 2034  
 DAYTRON 2011  
 DECCA 2001, 2035  
 DE GRAAF 2022, 2043  
 DENON 2022  
 DUAL 2021  
 DUMONT 2001, 2035, 2037  
 DYNATECH 2001  
 ELBE 2018  
 ELCATECH 2034  
 ELECTROHOME 2017  
 ELECTROPHONIC 2017  
 EMEREX 2012  
 EMERSON 2001, 2002, 2017, 2023, 2040, 2046, 2051, 2052, 2059, 2078, 2083  
 ESC 2057, 2059  
 FIDELITY 2001  
 FINLANDIA 2035, 2037  
 FINLUX 2001, 2022, 2035, 2037  
 FIRSTLINE 2017, 2023, 2024, 2034, 2052  
 FISHER 2025, 2026, 2030, 2037  
 FRONTTECH 2011  
 FUJI 2015

FUNAI	2001	MATSUI	2004, 2016, 2036, 2052, 2070, 2072
GARRARD	2001	MATSUSHITA	2015, 2042, 2055
GE	2015, 2027, 2032, 2057	MEI	2015
GEC	2035	MELECTRONIC	2018
GENERAL	2011, 2028	MEMOREX	2001, 2015, 2017, 2019, 2025, 2026, 2027, 2037, 2052, 2057, 2062, 2085, 2087, 2088
GOLDHAND	2034	MEMPHIS	2034
GOLDSTAR	2017, 2018, 2053, 2079	METZ	2003, 2005, 2017, 2042, 2048, 2055, 2069
GOODMANS	2001, 2017, 2034, 2059, 2075	MGA	2023, 2057
GO VIDEO	2077, 2081	MGN TECHNOLOGY	2057
GRAETZ	2005, 2021, 2037, 2057	MINCRVA	2048
GRANADA	2025, 2035, 2037	MINERVA	2005, 2010, 2048
GRADIENTE	2001, 2008	MINOLTA	2022
GRANDIN	2001, 2017, 2034	MOTOROLA	2015, 2027
HANSEATIC	2017	MTC	2001, 2057
HARMAN/KARDON	2018, 2035	MULTITECH	2001, 2034
HARLEY DAVIDSON	2001	MURPHY	2001
HARWOOD	2034	NAD	2031
HCM	2034	NATIONAL	2054
HEADQUARTER	2025	NEC	2018, 2020, 2021, 2033, 2037
HINARI	2004, 2034, 2057, 2072	NECKERMANN	2035
HI-Q	2026	NESSCO	2034
HUGHES NETWORK SYSTEMS	2022	NIKKO	2017
HYPSON	2034	NIKON	2014
IMPERIAL	2001	NOBLEX	2057
INGERSOL	2004	NOKIA	2021, 2025, 2037, 2038, 2057
INTERFUNK	2035	NORDMENDE	2021, 2061, 2064, 2065, 2074
ITT	2005, 2021, 2025, 2037, 2038, 2057, 2074	OCEANIC	2001, 2021
ITV	2017, 2059	OKANO	2063, 2070
JENSEN	2021	OLYMPUS	2015, 2054
KAISUI	2034	OPTIMUS	2017, 2027, 2031, 2037, 2042, 2077, 2086, 2087, 2088
KEC	2017, 2059	OSAKI	2001, 2017, 2034
KENDO	2038, 2052	OTTO VERSAND	2035
KENWOOD	2018, 2021, 2033	PALLADIUM	2005, 2017, 2021, 2034
KLH	2034	PATHE MARCONI	2021
KODAK	2015, 2017	PATHE CINEMA	2016
KORPEL	2034	PENTAX	2022
LAYCO	2034	PENNY	2015, 2017, 2018, 2020, 2022, 2057
LENCO	2059	PERDIO	2001
LG	2079	PHILCO	2015, 2018, 2052, 2078
LLOYD'S	2001, 2051	PHONOLA	2035
LOEWE	2004, 2005, 2017, 2035	PILOT	2017
LOGIK	2004, 2034, 2057	PORTLAND	2011
LUXOR	2023, 2025, 2027, 2037, 2038	PROFEX	2066
LXI	2017	PROFITRONIC	2057
M ELECTRONIC	2001	PROLINE	2001
MAGNASONIC	2059	PROSCAN	2032
MAGNAVOX	2001, 2015, 2019, 2035		
MAGNIN	2057		
MANESTH	2024, 2034		
MARANTZ	2003, 2005, 2015, 2035		
MARTA	2017		

PROTEC	2034	SUNSTAR	2001
PULSAR	2019	SUNTRONIC	2001
PYE	2035	SYLVANIA	2001, 2015, 2023, 2035
QUARTER	2025	SYMHONIC	2001
QUARTZ	2025	TASHIKO	2001
QUASAR	2015, 2042, 2087	TATUNG	2001, 2021, 2035
QUELLE	2035	TEAC	2001, 2021
RADIO SHACK	2001, 2085	TEC	2011
RADIOLA	2035	TECHNICS	2015, 2042, 2054
RADIX	2017	TEKNIKA	2001, 2015, 2007, 2017, 2028
RANDEX	2017	TELEAVIA	2021
RCA	2015, 2022, 2027, 2032, 2038, 2057	TELEFUNKEN	2021, 2047, 2058, 2064, 2074
REALISTIC	2001, 2015, 2017, 2025, 2026, 2027, 2037	TENOSAL	2034
REX	2021, 2074	TENSAI	2001, 2066
RFT	2075	THOMAS	2001
RICOH	2014	THORN	2016, 2021, 2037
ROADSTAR	2017, 2034, 2057, 2059	TMK	2051, 2057
RUNCO	2019	TOTEVISION	2017, 2057
SABA	2021, 2049, 2050, 2061, 2064, 2065, 2074	TOWADA	2066
SAISHO	2004, 2016, 2036, 2052	UHER	2057
SALORA	2023, 2025, 2038	UNITECH	2057
SANKY	2019, 2027	UNIVERSUM	2001, 2006, 2010, 2017, 2035, 2038, 2048, 2057, 2067
SANSUI	2001, 2021, 2033, 2052, 2058, 2078	VECTOR	2024
SAMSUNG	2024, 2057, 2076, 2077	VECTOR RESEARCH	2018, 2020
SAVILLE	2072	VICTOR	2008, 2021, 2033
SBR	2035	VIDEO CONCEPTS	2020, 2024
SCHAUB LORENZ	2001, 2005, 2021, 2037	VIDEOSONIC	2057
SCHNEIDER	2001, 2034, 2035	WARDS	2001, 2015, 2022, 2026, 2027, 2032, 2034, 2035, 2057
SCOTT	2023, 2024, 2040, 2046	WHITE WESTINGHOUSE	2052, 2059
SEARS	2001, 2015, 2017, 2022, 2025, 2026, 2037	XR-1000	2001
SEG	2057, 2066	XR-1001	2015
SEI	2004, 2035	XR-1002	2034
SELECO	2021	YAMAHA	2018
SEMP	2024	YAMISHI	2034
SENTRA	2011	YOKAN	2034
SHINTOM	2034, 2037	YOKO	2011, 2057
SHOGUN	2057	ZENITH	2001, 2014, 2019, 2052, 2078
SHORAI	2004	PIONEER	2031, 2033, 2035, 2044, 2056
SIEMENS	2003, 2005, 2010		
2017, 2030, 2035	2037, 2048		
SILVA	2017		
SINGER	2024, 2034		
SINUDYNE	2004, 2035		
SOLAVOX	2011		
SONOLOR	2025		
SONTEC	2017		
STS	2022		
SUNKAI	2070		

### SATELLITE TUNER



Manufacturer	Code
ABSAT	4006
AST	4027
ALBA	4029, 4034, 4037, 4052
ALDES	4019
AMSTRAD	4003, 4016, 4025, 4038, 4039, 4042
ANKARO	4013, 4019, 4030, 4044
ANTTRON	4009, 4034



ARMSTRONG	4015	KREISELMEYER	4008
ASTRA	4005	KYOSTAR	4034
ASTRO	4008, 4039, 4045	LA SAT	4043, 4045
AVALON	4031	LENCO	4034
AXIS	4030, 4046	LENNOX	4050
BT	4053	LUPUS	4030
BEKO	4010	LUXOR	4005, 4049
BEST	4030	MANHATTAN	4037, 4045, 4050
BLAUPUNKT	4008	MARANTZ	4011
BOCA	4015, 4043	MASPRO	4004, 4023
BRAIN WAVE	4022	MATSUI	4024, 4048
BRITISH SKY BROADCASTING	4058	MEDIASAT	4059
BUSH	4002	MEDIAMARKT	4015
CNT	4045	MINERVA	4048
CAMBRIDGE	4024	MORGAN'S	4015, 4043
CANAL SATELLITE	4059	NAVEX	4022
CANAL+	4059	NEUHAUS	4039
CHANNEL MASTER	4029	NEUSAT	4057
COMLINK	4019	NEWHAUS	4013
CONNEXIONS	4031	NIKKO	4028
CROWN	4015	NOKIA	4005, 4032, 4037, 4049, 4054, 4063
CYRUS	4011	NORDMENDE	4029
D-BOX	4054	ORBITECH	4039
DDC	4029	OXFORD	4024
DNT	4011, 4031	PACE	4002, 4009, 4014, 4023, 4037, 4055, 4058
ECHOSTAR	4031, 4036, 4061	PALLADIUM	4048
EMANON	4034	PALSAT	4039
FTE HUMAX	4060	PANDA	4037
FERGUSON	4002, 4009, 4010, 4023	PHILIPS	4007, 4011, 4020, 4037, 4048, 4059
FIDELITY	4016	PHONOTREND	4019, 4050
FINLUX	4005, 4024, 4032, 4037	PIONEER	4021, 4059
FRACARRO	4061	PLANET	4061
FREECOM	4034	PROMAX	4037
FUBE	4030, 4031, 4034	PROSAT	4019
G-SAT	4009	QUADRAL	4029, 4044
GALAXIS	4019, 4057, 4060	RADIOLA	4011
GENERAL INSTRUMENT	4012	RADIX	4031, 4064
GOLD BOX	4059	RFT	4011, 4013, 4019
GOODING	4048	SAT	4027, 4038
GOODMANS	4010	SABA	4023, 4045
GRUNDIG	4008, 4010, 4048	SABRE	4037
HINARI	4009	SAGEM	4056
HIRSCHMANN	4008, 4032, 4039, 4040, 4049	SALORA	4005
HITACHI	4037	SATCOM	4026, 4051
HOUSTON	4053	SATEC	4009
HUTH	4013, 4015, 4019, 4026	SATMASTER	4026
ITT	4005	SATPARTNER	4022, 4034, 4040, 4045
INVIDEO	4061	SCHWAIGER	4009, 4041
INTERVISION	4050	SEEMANN	4031, 4046
JVC	4048		
JOHANSSON	4022		
KATHREIN	4004, 4006, 4008, 4011, 4035, 4041		

SEG	4030, 4034	JASCO	3007
SIEMENS	4008	JERROLD	3002, 3004, 3005, 3006, 3007, 3020, 3031, 3046
SKYMASTER	4019, 4044, 4051	LG ALPS	3044
SONY	4017, 4018	MEMOREX	3001
STRONG	4062	MNET	3009, 3028
SUNSTAR	4043	NOW	3041
TPS	4056	OAK	3009
TANTEC	4023, 4037	PACIFIC	3039
TECHNISAT	4001, 4039	PANASONIC	3001, 3013
TECHNILAND	4026	PARAGON	3001
TELEFUNKEN	4034	PULSAR	3001
TELEKA	4015, 4052	PVP STEREO VISUAL	
TELESAT	4051	MATRIX	3002
THOMSON	4037, 4059	PIONEER	3010, 3014, 3018, 3036
TONNA	4026, 4053	QUASAR	3001
TRIAD	4027	RADIO SHACK	3007
TRIASAT	4040	REMBRANDT	3004
UNITOR	4022	RUNCO	3001
UNIVERSUM	4008, 4049	SAMSUNG	3014, 3040
VENTANA	4011	SATBOX	3024
VORTEC	4034	SIGNAL	3007
VTECH	4027	SIGNATURE	3004
WINERSAT	4022	STS	3015
WISI	4008, 4027, 4031, 4037	SALORA	3026
XSAT	4006, 4065	SCIENTIFIC	3003, 3032, 3049
XCOM MULTIMEDIA	4065	SCIENTIFIC ATLANTA	3003, 3008, 3021
ZEHNDER	4033, 4045, 4047	SEAWOO	3045

**CABLE TV**

<b>Manufacturer</b>	<b>Code</b>
ABC	3002, 3003, 3004, 3006, 3008
ANDOVER	3037
BELL & HOWELL	3006
BIRGMINGHAM CABLE COMMUNICATION	3020
BRITISH TELECOM	3002, 3012
CABLETIME	3016, 3019, 3025, 3029
CONTEC	3009
CLYDE	3011
CRYPTOVISION	3038
DAEHAN	3043
DAERYUNG	3003
DECSAT	3027
EVERQUESST	3007
FILMNET	3028
FRANCE TELECOM	3030
GEC	3011
GEMINI	3007
GENERAL INSTRUMENT	3004, 3020, 3031, 3046
GOLDSTAR	3014, 3047
GRUNDIG	3035
HITACHI	3004

## Troubleshooting

Incorrect operations are often mistaken for trouble and malfunctions. If you think that there is something wrong with this component, check the points below. Sometimes the trouble may lie in another component. Investigate the other components and electrical appliances being used. If the trouble cannot be rectified even after exercising the checks listed below, ask your nearest Pioneer authorized service center or your dealer to carry out repair work.

Problem	Remedy
The power does not turn on.	<ul style="list-style-type: none"> <li>• Connect the power plug to the wall outlet.</li> <li>• Disconnect the power plug from the outlet, and insert again.</li> <li>• Make sure there are no loose strands of speaker wire touching the rear panel. This could cause the receiver to shut off automatically.</li> </ul>
No sound is output when a function is selected.	<ul style="list-style-type: none"> <li>• Make sure the component is connected correctly (refer to pages 13–18).</li> <li>• Press <b>MUTE</b> on the remote control to turn muting off.</li> <li>• Adjust the <b>MASTER VOLUME</b>.</li> <li>• Press the <b>MONITOR</b> button to turn monitoring off.</li> </ul>
No image is output when a function is selected.	<ul style="list-style-type: none"> <li>• Make sure the component is connected correctly (refer to pages 13–18).</li> <li>• Select the correct component (use the <b>MULTI JOG/INPUT SELECTOR</b> dial or the <b>MULTI CONTROL</b> buttons on the remote).</li> </ul>
Considerable noise in radio broadcasts.	<ul style="list-style-type: none"> <li>• Tune in the correct frequency.</li> <li>• Connect the antenna (refer to page 18).</li> <li>• Route all cables away from the antenna terminals and wires.</li> <li>• Fully extend the FM wire antenna, position for best reception, and secure to a wall.</li> <li>• Connect an outdoor FM antenna (refer to page 18).</li> <li>• Adjust the direction and position for best reception.</li> <li>• Connect an additional internal or external AM antenna (refer to page 19).</li> <li>• Turn off the equipment causing the noise or move it away from the receiver.</li> <li>• Place the antenna farther away from the equipment causing the noise.</li> </ul>
Broadcast stations cannot be selected automatically.	<ul style="list-style-type: none"> <li>• Connect an outdoor antenna (refer to page 18).</li> </ul>

Problem	Remedy
No sound from surround or center speakers.	<ul style="list-style-type: none"> <li>Refer to <i>Speaker setting</i> on page 37 to check the speaker settings.</li> <li>Refer to <i>Setting the relative volume level of each channel</i> on page 42 to check the speaker levels.</li> <li>Connect the speakers properly (refer to page 19–21).</li> </ul>
No sound from surround back speakers.	<ul style="list-style-type: none"> <li>Refer to <i>Surround back speaker setting</i> on page 40 to check the surround back speaker settings.</li> <li>Refer to the table on page 31 to make sure the 6.1 channel setting and the sound mode are set for surround back sound.</li> </ul>
Noise during playback of a cassette deck.	<ul style="list-style-type: none"> <li>Move the cassette deck further from your receiver, until the noise disappears.</li> </ul>
Sound is produced from other components, but not from LD or DVD player.	<ul style="list-style-type: none"> <li>Set the <b>SIGNAL SELECT</b> to <b>AUTO</b>, <b>DIGITAL</b> or <b>ANALOG</b> according to the type of connections made. (refer to page 32).</li> <li>Set the digital input settings correctly (refer to page 41).</li> <li>Make digital connections (refer to page 14) and set the <b>SIGNAL SELECT</b> to <b>DIGITAL</b> (refer to page 32).</li> <li>Refer to the instruction manual supplied with the DVD player.</li> </ul>
No sound is output or a noise is output when software with DTS is played back.	<ul style="list-style-type: none"> <li>Set the digital volume level of the player to full, or to the neutral position.</li> </ul>
When a search is performed by a DTS compatible CD player during playback, noise is output.	<ul style="list-style-type: none"> <li>This is not a malfunction, but be sure to turn the volume down to prevent the output of loud noise from your speakers.</li> </ul>
Can't operate the remote control.	<ul style="list-style-type: none"> <li>Replace the batteries (refer to page 6).</li> <li>Operate within 23 feet ( 7 m), 30° of the remote sensor on the front panel (refer to page 6).</li> <li>Remove the obstacle or operate from another position.</li> <li>Avoid exposing the remote sensor on the front panel to direct light.</li> </ul>
The display is dark or off.	<ul style="list-style-type: none"> <li>Press <b>FL DIMMER</b> on the remote control repeatedly to return to the default.</li> </ul>

**Note**

If the unit does not operate normally due to external effects such as static electricity disconnect the power plug from the outlet and insert again to return to normal operating conditions.

## Specifications

### Amplifier Section

Continuous average power output of 110 watts\* per channel, min., at 8 ohms, from 20 Hz to 20,000 Hz with no more than 0.2 %\*\* total harmonic distortion (front).

#### Continuous Power Output

Front ..... 110 W per channel  
(1kHz, 1.0 %, 8  $\Omega$ )  
Center ..... 110 W (1kHz, 1.0 %, 8  $\Omega$ )  
Surround ..... 110 W per channel  
(1kHz, 1.0 %, 8  $\Omega$ )

#### Input (Sensitivity/Impedance)

CD, VCR/DVR, CD-R/TAPE/MD,  
DVD/LD, TV/SAT ..... 200 mV/47 k $\Omega$

#### Frequency Response

CD, VCR/DVR, CD-R/TAPE/MD, DVD/LD,  
TV/SAT ..... 5 Hz to 100,000 Hz dB

#### Output (Level/Impedance)

VCR/DVR REC, CD-R/TAPE/  
MD REC ..... 200 mV/2.2 k $\Omega$

#### Tone Control

BASS .....  $\pm$  6 dB (100 Hz)  
TREBLE .....  $\pm$  6 dB (10 kHz)  
LOUDNESS ..... +9 dB/+9 dB  
(100 Hz/10 kHz)

#### Signal-to-Noise Ratio (IHF, short circuited, A network)

CD, VCR/DVR, CD-R/TAPE/MD,  
DVD/LD, TV/SAT ..... 96 dB

#### Signal-to Noise Ratio [EIA, at 1 W (1 kHz)]

CD, VCR/DVR, CD-R/TAPE/MD,  
DVD/LD, TV/SAT ..... 79 dB

## Video Section

### Input (Sensitivity/Impedance)

VCR/DVR, DVD/LD, TV/SAT ..... 1 Vp-p/75  $\Omega$

### Output (Level/Impedance)

VCR/DVR ..... 1 Vp-p/75  $\Omega$

### Frequency Response

VCR/DVR, DVD/LD,  
TV/SAT  $\Rightarrow$  MONITOR ..... 5 Hz to 7 MHz  $^{-9}$  dB  
Signal-to-Noise Ratio ..... 55 dB  
Cross Talk ..... 55 dB

## FM Tuner Section

Frequency Range ..... 87.5 MHz to 108 MHz  
Usable Sensitivity ..... Mono:13.2 dBf, IHF  
(1.3  $\mu$ V/ 75  $\Omega$ )  
50 dB Quieting Sensitivity ..... Mono: 20.2 dB  
Stereo: 38.6 dBf  
Signal-to-Noise Ratio ..... Mono: 73 dB  
(at 85 dBf)  
Stereo: 70 dB (at 85 dBf)  
Distortion ..... Stereo: 0.5 % (1 kHz)  
Alternate Channel Selectivity ..... 60 dB  
(400 kHz)  
Stereo Separation ..... 40 dB (1 kHz)  
Frequency Response ..... 30 Hz to 15 kHz  
( $\pm$ 1 dB)  
Antenna Input (DIN) ..... 75  $\Omega$  unbalanced

## AM Tuner Section

Frequency Range ..... 530 kHz to 1,700 kHz  
Sensitivity (IHF, Loop antenna) ..... 350  $\mu$ V/m  
Selectivity ..... 25 dB  
Signal-to-Noise Ratio ..... 50 dB  
Antenna ..... Loop antenna

## Miscellaneous

Power Requirements .....	AC 120 V, 60Hz
Power Consumption .....	300W, 420 VA
In Standby .....	1 W
AC Outlet .....	100 W MAX. (SWITCHED)
Dimensions .....	420 (W) x 158 (H) x 401 (D) mm
	(16-9/16 (W) x 6-4/16
	(H) x 15-6/16 (D) in.)
Weight (without package) .....	10.5 kg
	(23.1 lb)

## Furnished Parts

AM loop antenna .....	1
FM wire antenna .....	1
Dry cell batteries (AA size IEC LR6) .....	2
Remote control .....	1
Operating instructions .....	1



### Note

Specifications and the design are subject to possible modifications without notice, due to improvements.

\* Measured pursuant to the Federal Trade Commission's Trade Regulation rule on Power Output Claims for Amplifiers.

\*\* Measured by Audio Spectrum Analyzer.

## Cleaning the unit

- Use a polishing cloth or dry cloth to wipe off dust and dirt.
- When the surfaces are dirty, wipe with a soft cloth dipped in some neutral cleanser diluted five or six times with water, and wrung out well, and then wipe again with a dry cloth. Do not use furniture wax or cleansers.
- Never use thinners, benzene, insecticide sprays or other chemicals on or near this unit, since these will corrode the surfaces.



Should this product require service in the U.S.A. and you wish to locate the nearest Pioneer Authorized Independent Service Company, or if you wish to purchase replacement parts, operating instructions, service manuals, or accessories, please call the number shown below.

**8 0 0 – 4 2 1 – 1 4 0 4**

Please do not ship your product to Pioneer without first calling the Customer Service Department at the above listed number for assistance.

PIONEER ELECTRONICS SERVICE, INC.  
CUSTOMER SERVICE DEPARTMENT  
P.O. BOX 1760, LONG BEACH,  
CA 90801-1760, U.S.A.

For warranty information please see the Limited Warranty sheet included with your product.

Should this product require service in Canada, please contact a Pioneer Canadian Authorized Dealer to locate the nearest Pioneer Authorized Service Company in Canada.  
Alternatively, please contact the Customer Service Department at the following address:

PIONEER ELECTRONICS (USA) INC.  
Customer Service Department  
300 Allstate Parkway, Markham, Ontario L3R OP2  
(905) 479-4411  
1-877-283-5901

For warranty information please see the Limited Warranty sheet included with your product.

Si ce produit doit être réparé au Canada, veuillez vous adresser à un distributeur autorisée Pioneer au Canada pour obtenir le nom de la Société de Service Autorisée Pioneer le plus près de chez vous. Ou encore, veuillez vous communiquer avec le Service de Clientèle de Pioneer:

Pioneer électroniques du Canada, Inc.  
Département de service au consommateurs  
300 Allstate Parkway, Markham, Ontario L3R OP2  
(905) 479-4411  
1-877-283-5901

Pour obtenir des renseignements sur la garantie, veuillez vous reporter au feuillet sur la Garantie Limitée qui accompagne le produit.

Published by Pioneer Corporation.  
Copyright © 2002 Pioneer Corporation.  
All rights reserved.

---

## **PIONEER CORPORATION**

4-1, Meguro 1-Chome, Meguro-ku, Tokyo 153-8654, Japan

### **PIONEER ELECTRONICS [USA] INC.**

P.O. BOX 1540, Long Beach, California 90801-1540, U.S.A.

### **PIONEER ELECTRONICS OF CANADA, INC.**

300 Allstate Parkway, Markham, Ontario L3R OP2, Canada

### **PIONEER EUROPE NV**

Haven 1087, Keetberglaan 1, B-9120 Melsele, Belgium TEL: 03/570.05.11

### **PIONEER ELECTRONICS AUSTRALIA PTY. LTD.**

178-184 Boundary Road, Braeside, Victoria 3195, Australia, TEL: [03] 9586-6300

### **PIONEER ELECTRONICS DE MEXICO S.A. DE C.V.**

San Lorenzo 1009 3er Piso Desp. 302 Col. Del Valle Mexico D.F. C.P. 03100  
TEL: 55-688-52-90